

THROUGH THE WAVES



ATELIER REHWALDT
15120 ÚSTAV KRAJINÁŘSKÉ ARCHITEKTURY
PRAGUE, SOUTH TOWN: MIKULOVA

TEREZA NOVÁKOVÁ
AT3K – SMALL SCALE
ZS 2021–2022

introduction



ANNOTATION

Mikulova street park – currently a space without name, without function, without people. Everyone passing by, no one staying. A space without use, however, with big potential.

How to make people stay? The goal of the design is to create a much needed community space as well as a playscape for both young and old, calm and wild. The form – organic terrain modelation – is inspired by South town's tradition with building small hills from excessive soil.

context

location

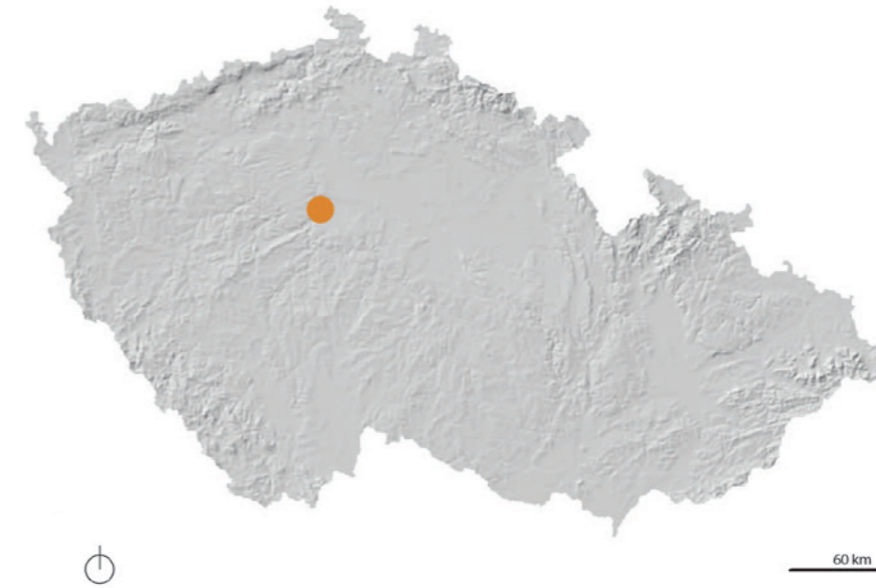

The Mikulova street space is located in Prague in the South town housing estate complex. In this complex that spreads over almost 10 km² are approximately 80 000 inhabitants, a number that equals a bigger city. The construction of South town began in 1971. The urban concept, made a few years earlier, was really well designed. The whole area was supposed to be divided into five districts. Each district had its own center, and four of the districts were connected by the fifth, Central district. However, due to the communist regime, the important aspects of the urban plan were neglected in order for the construction to be fast, cheap and easy. Due to this, the housing estate complex today is facing many problems connected to the public space. The Mikulova street space is one of the spaces in between housing estates, that have currently no use.

wider relations – Prague 11



wider relations – close-up

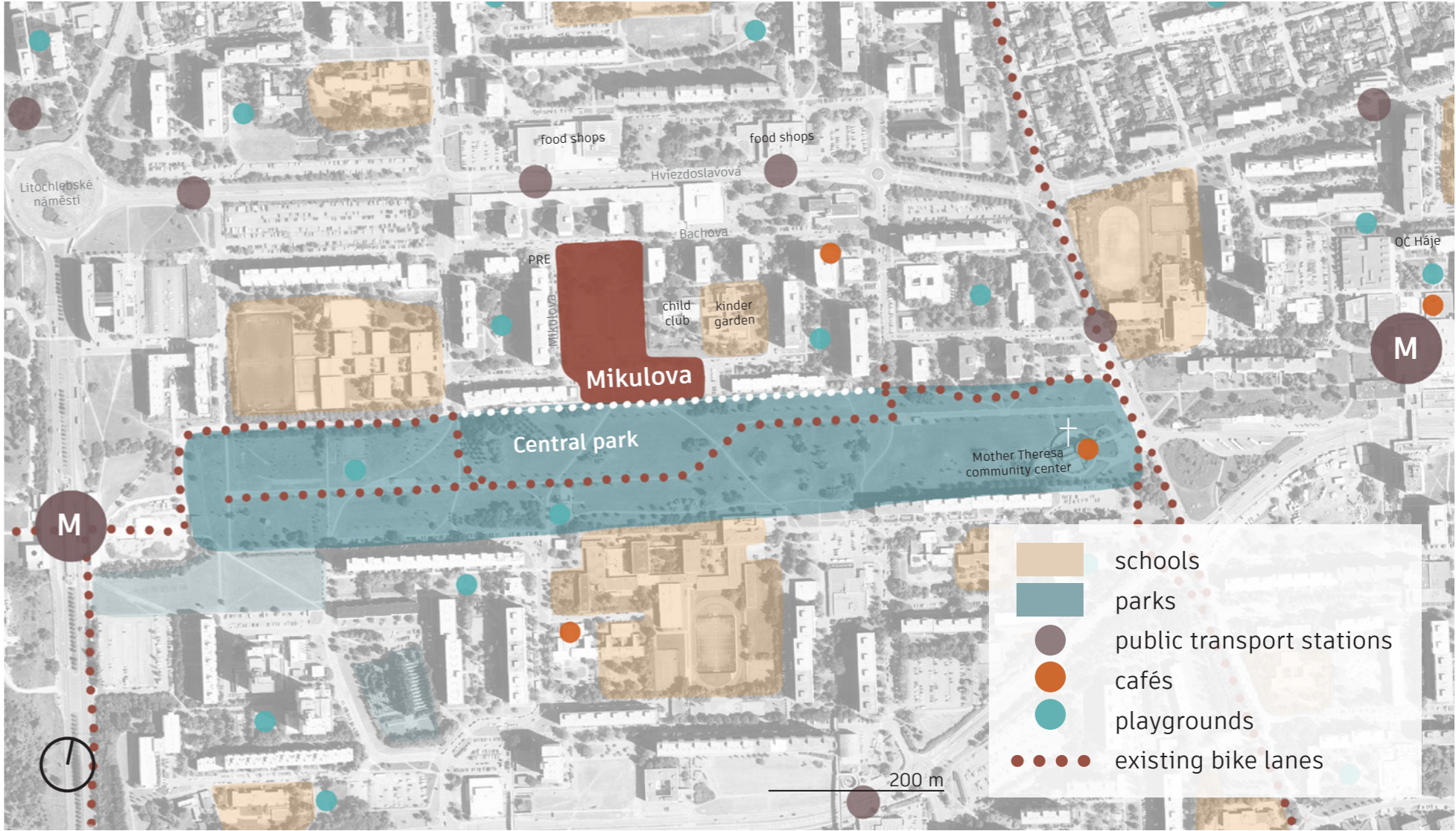

analysis

current situation

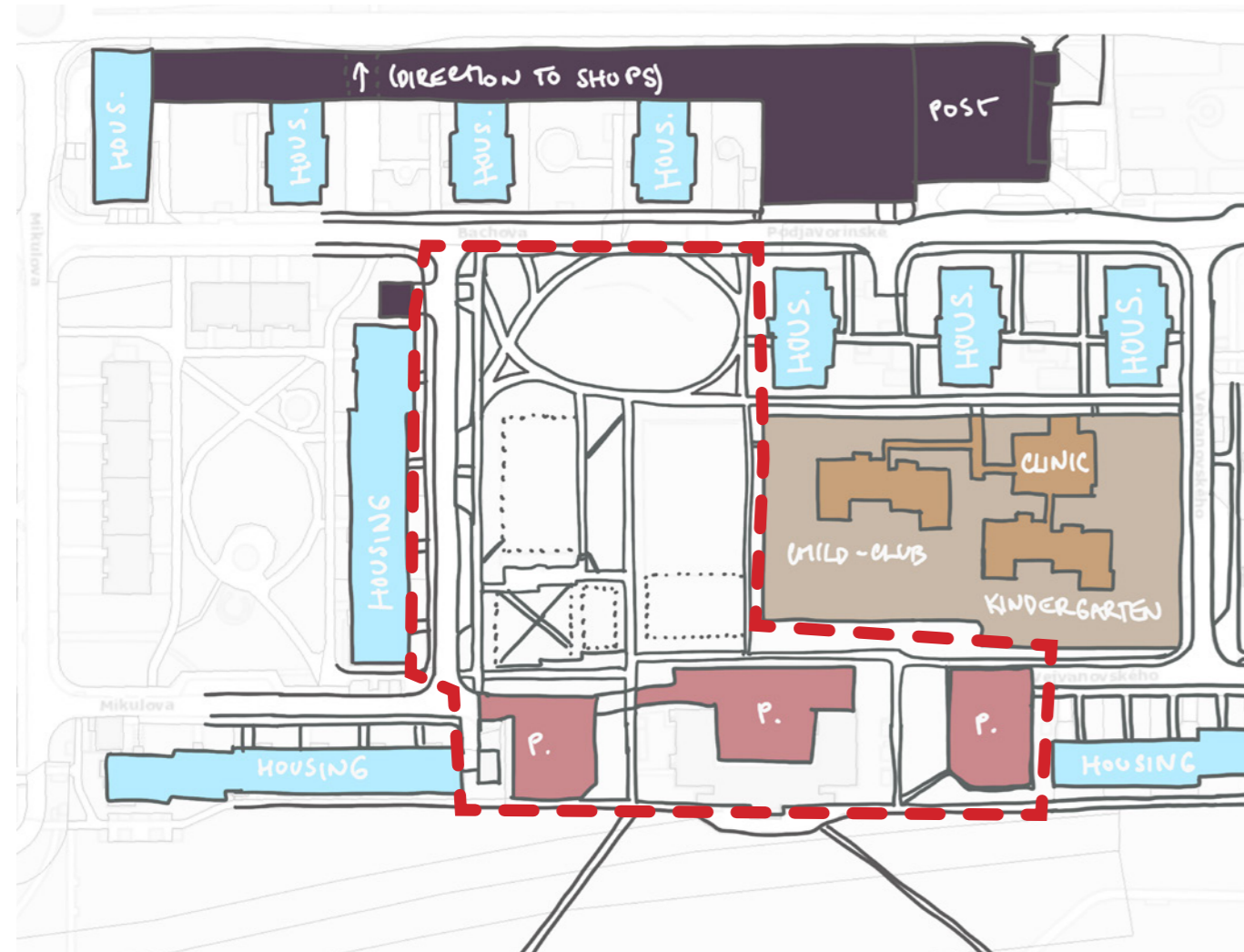

- - - Mikulova borders
- housing
- public amenities
- other buildings
- parking

The space is surrounded by housing estates, a kindergarten and child-club complex and Central park on the south border.

The southern part of the area is cover by parking spaces, the northern part is a small hill and in between are grass spaces and asphalt sports fields.

Even though the current concept is not working and the space is not being used, it still looks very cozy.

current situation – photos

parking



„wild“ hill area



big sports field area



small children's area



lawn area



concrete playground feature



topography



Most of the space is covered by grass, and there are also some asphalt sports fields. The path system is not really being used.



The space is mostly flat, except for the small hill in its northern part. On the southern edge of the area, there is the Central park that is also made up of hills. Both these hilly areas create a nice atmosphere in the Mikulova space.

current situation – strenghts and weaknesses

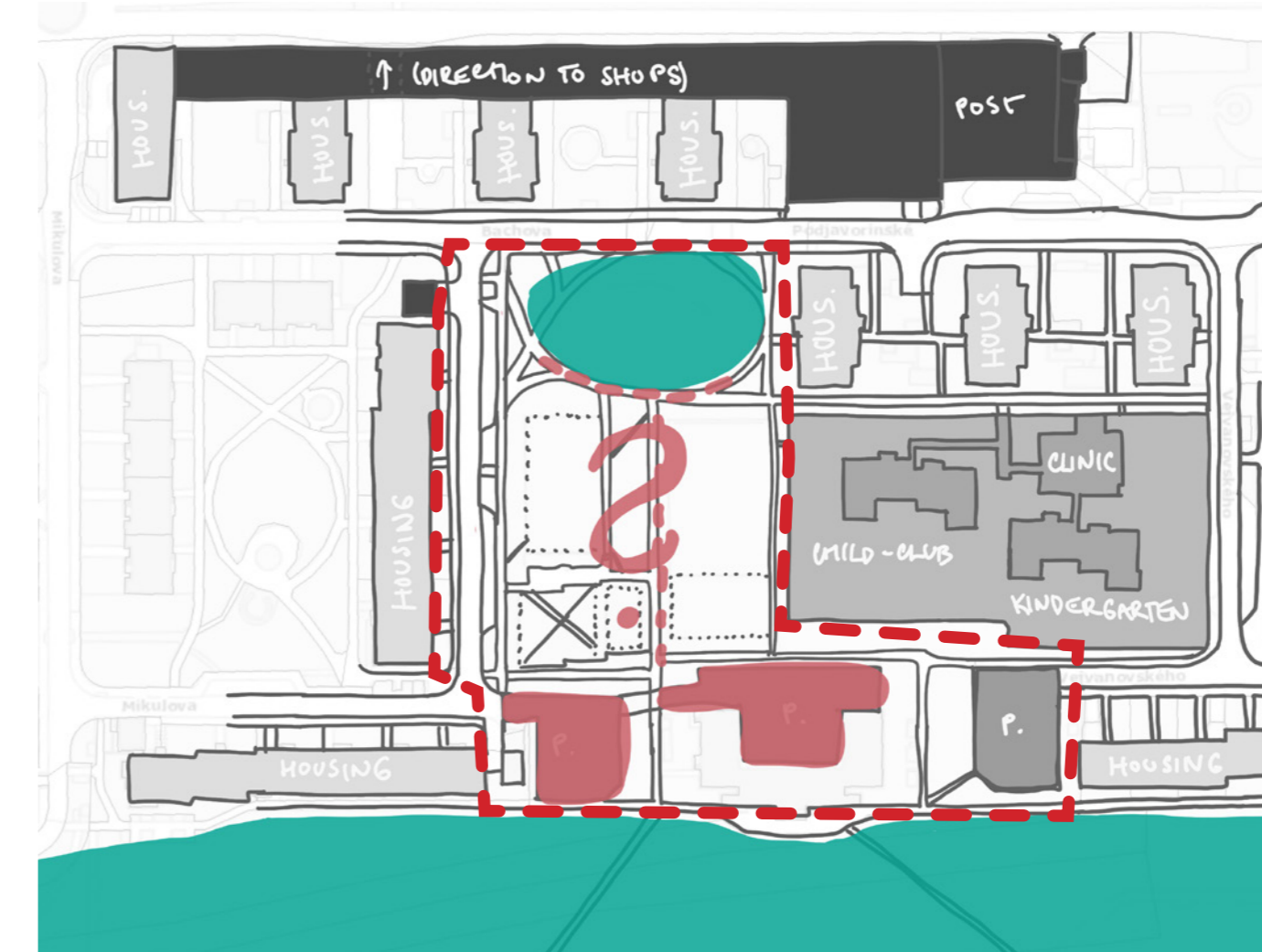

- - - Mikulova borders
- strenghts
- weaknesses

The biggest strenght of the space is its connection to Central park – a big amount of people visits the park, and they pass by the Mikulova space as well. Another positive aspect is the hill on the northern edge of the area – it creates a visual border from the further housing estate and make the space more cozy.

The weaknesses of the space are weirdly shaped parking spots and the whole concept of the space in the middle (path system as well as sports spaces) that is not working.

valuable visual connections

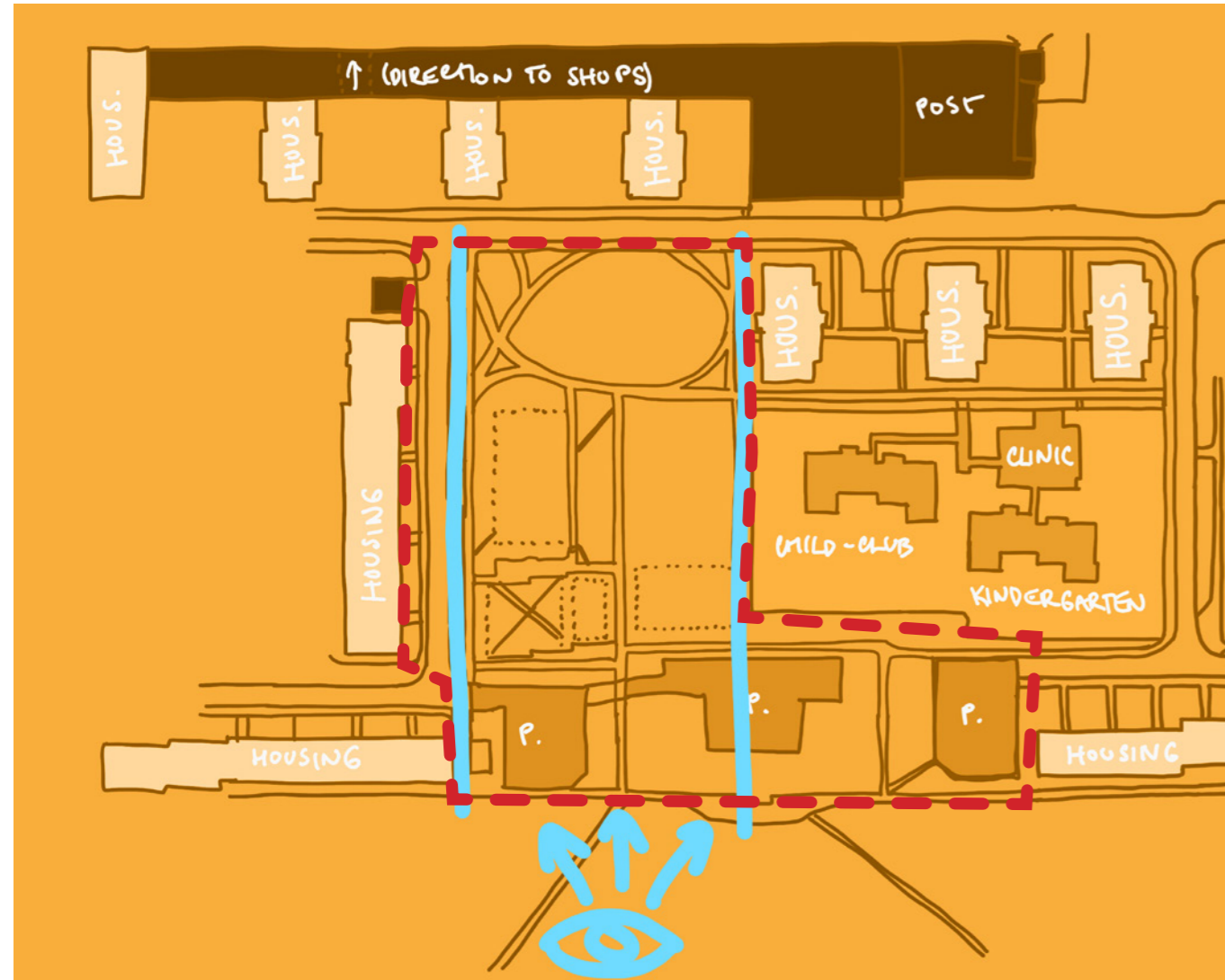

- - - Mikulova borders
- visual goals

One of the valuable aspects of the Mikulova street park is the visual connection from the Central park through the whole space to the small hill. This visual connection was further used in the design concept.

most used paths



- Mikulova borders
- most used paths – through
- most used paths – local buildings

People are mostly just passing through the space, and using the beaten paths rather than the solid paths.

SWOT analysis /analýza

STRENGTHS / SILNÉ STRÁNKY

- big space – big potential / velký prostor – velký potenciál
- terrain modelation / terénní modelace
- transparency and intimacy / přehlednost a intimita
- asphalt surface are great for wheels / asfaltové povrchy dobré pro kola
- some existing trees / některé existující stromy

WEAKNESSES / SLABÉ STRÁNKY

- no name space with no function / bezejmenný prostor bez funkce
- nothing to keep people here / nic tu lidi nedrží
- unmaintained / neudržovanost
- nonsensical paths and trees / špatně vedené cesty a stromy
- lack of mobiliar / nedostatek mobiliáře
- transformer station / trafostanice

OPPORTUNITIES / PŘÍLEŽITOSTI

- good traffic availability / dobrá dopravní dostupnost
- neighboring Central park / v sousedství Central parku
- great location for community functions / dobrá poloha pro komunitní funkce
- kindergarten a clinic / MŠ a psychiatrická klinika
- bicycle path near / cyklostezka v blízkosti
- people passing through / průchozí bod

THREATS / HROZBY

- could be dangerous at night / v noci může být nebezpečné
- vandalism risk (graffity) / riziko vandalismu (graffity)
- risk of no maintenance / riziko zanedbání
- disagreement of locals / nesouhlas sídlištních obyvatel

concept

design concept

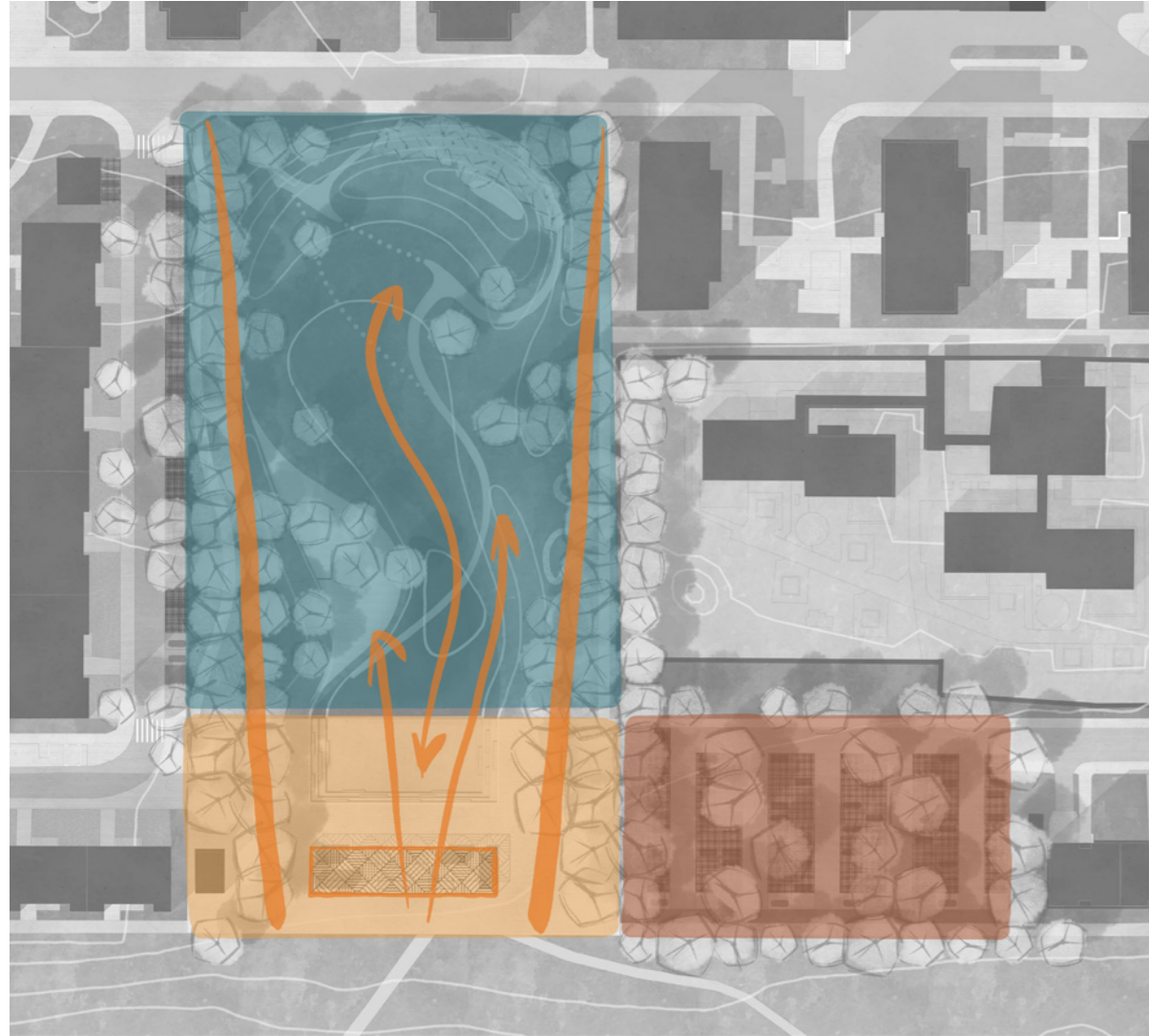

spaces and visual connections

- playscape
- community space
- parking
- visual connection

- The space is divided into three areas:
- the community space – community roof and amfitheater
 - the playscape – terrain and play-paths
 - parking

The community roof is supposed to create a visual entrance into the space – be a connection between the Mikulova street park and Central park.

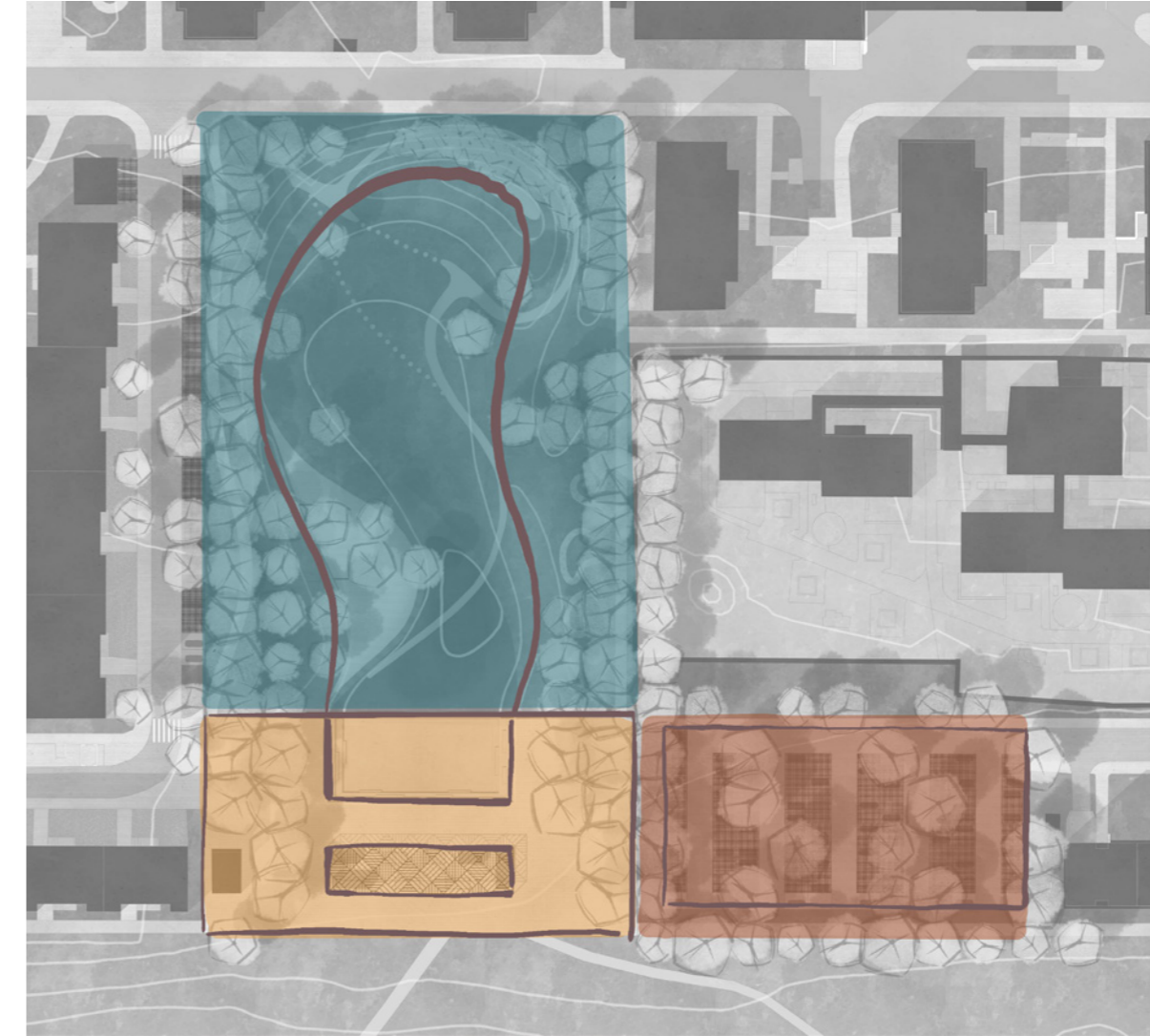

spaces and shapes

- playscape
- community space
- parking
- shaping



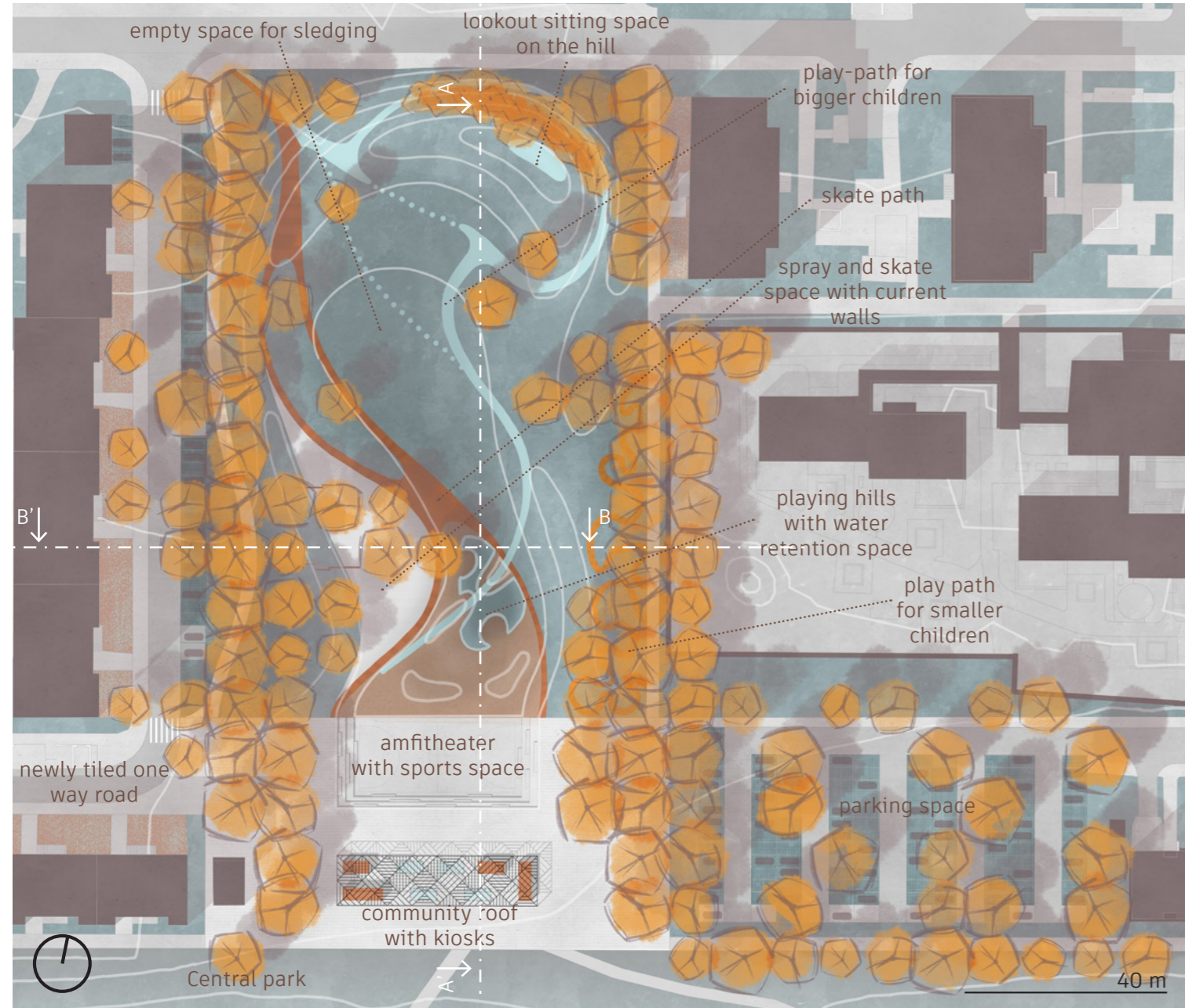

The shaping of the spaces also has a meaning – the community space and parking have the usual rectangular shapes, indicating a more formal area. The playscape is organic, indicating a more wild and playful area.

design



situation







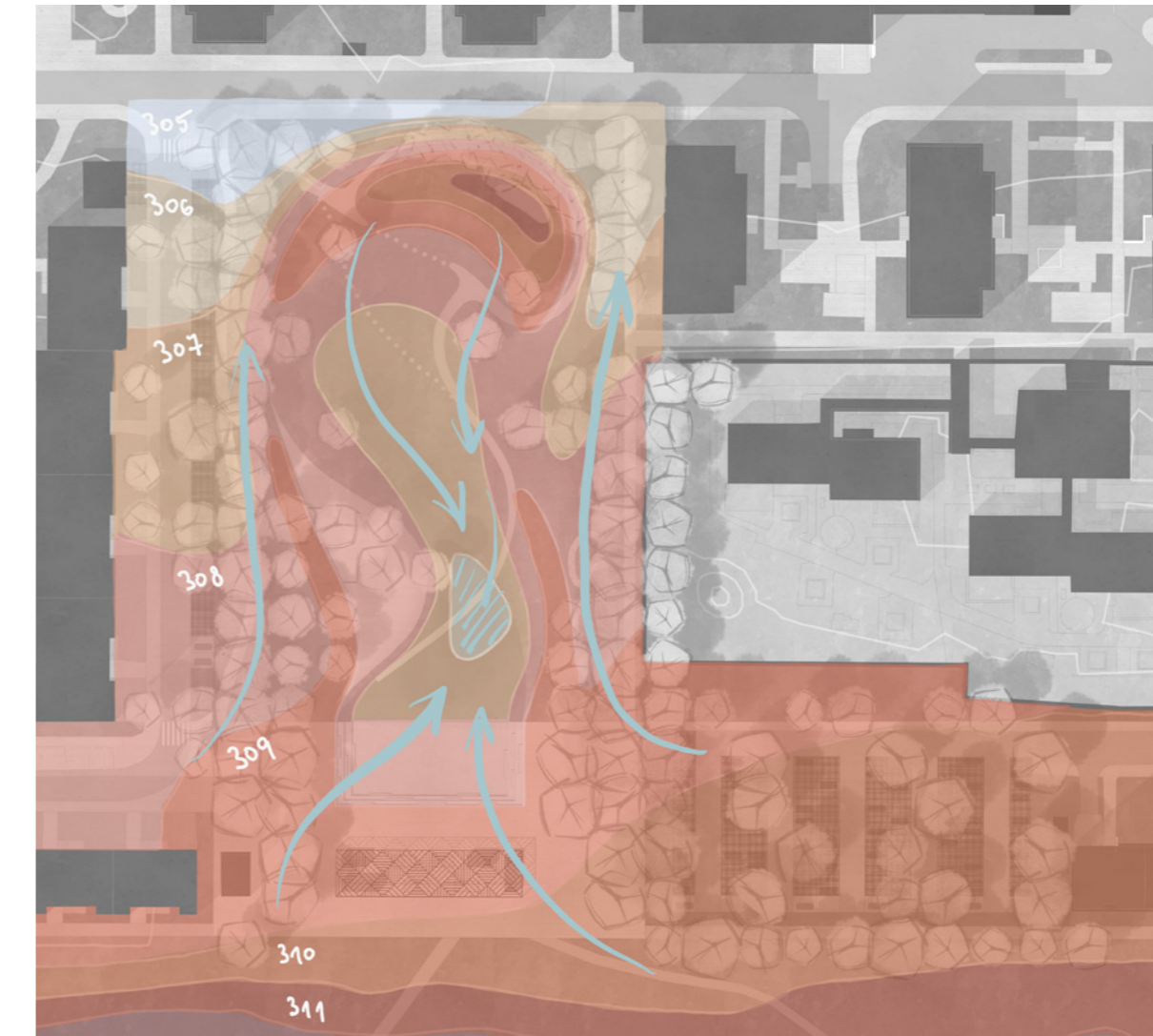

The community area has a roof for shade, kiosks and an amfitheater. The playscape terrain has a skate-path and a play-path for small as well as bigger children, and play hills with water retention.

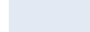
-  grass
-  concrete tiles – bigger
-  concrete tile – smaller
-  concrete tiles – driveable
-  grass paving
-  wetpour surface for play hills
-  colored asphalt for pump track
-  wetpour surface for play-path
-  steel and concrete elements of the harder play path
-  front gardens

schemes



terrain modeling and water flow

-  305
-  306
-  307
-  308
-  309
-  310
-  311
-  water flow

The terrain creates a bowl – the rainwater that falls in the center of the space flows into the water retention hills.

schemes

roads and paths

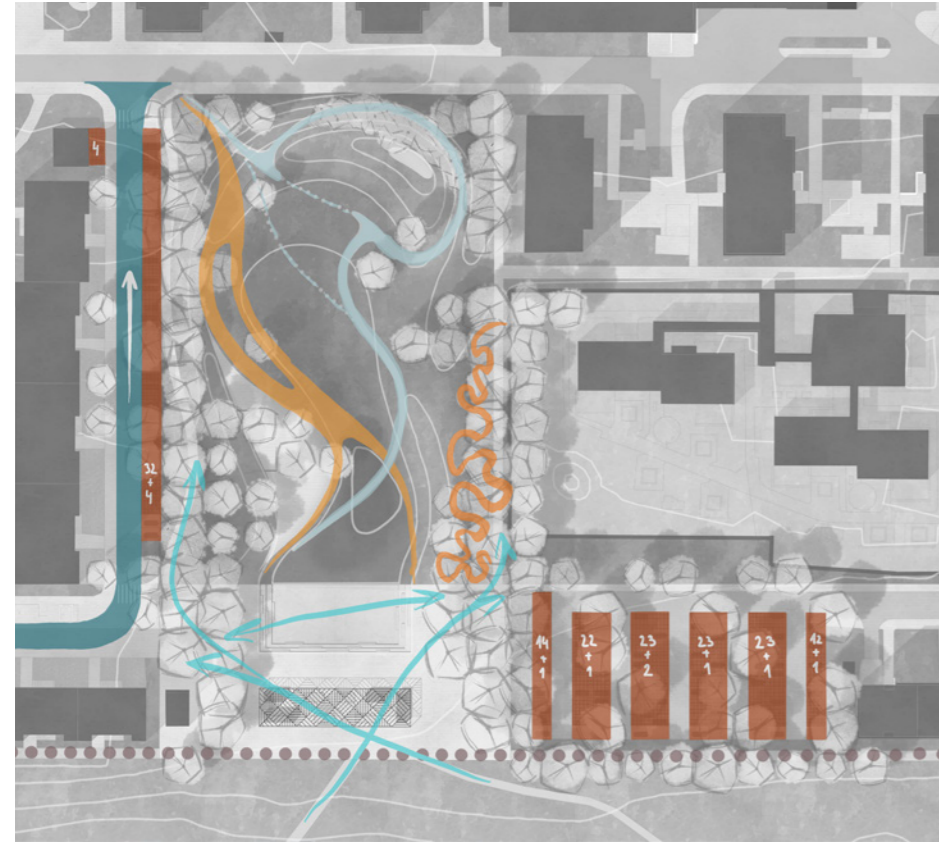

- one-way road
- parking
- skate-path
- play-path – hard
- play-path – easy
- pedestrian flow

paved surfaces

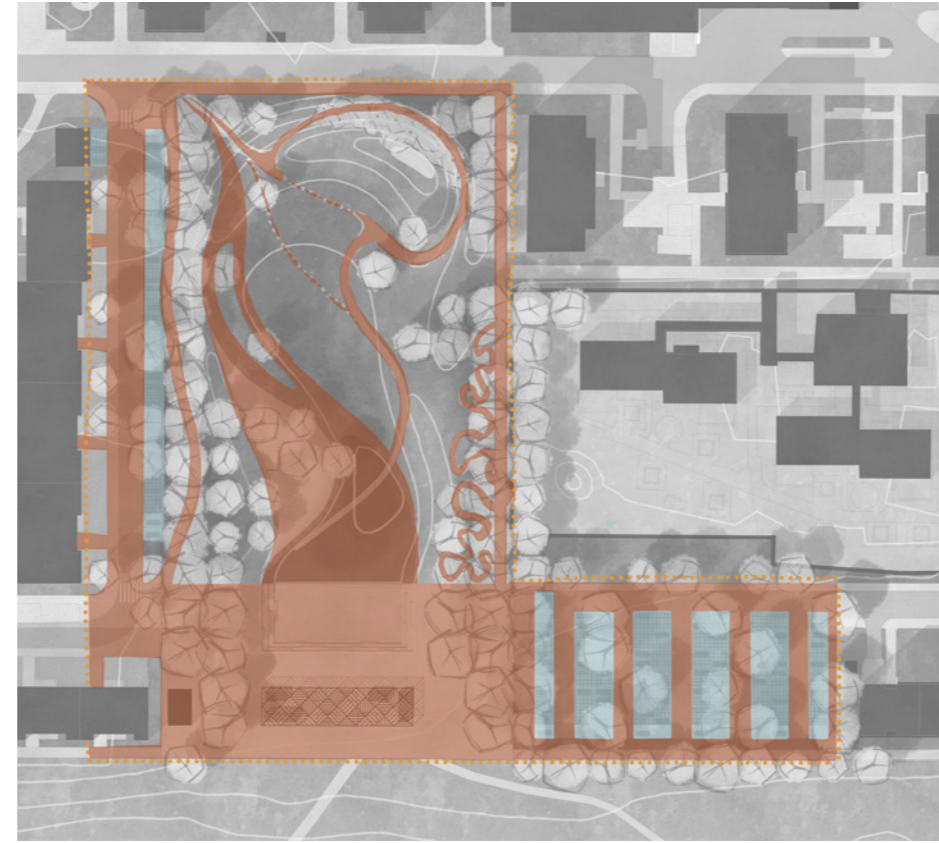

- waterproof
- permeable

schemes

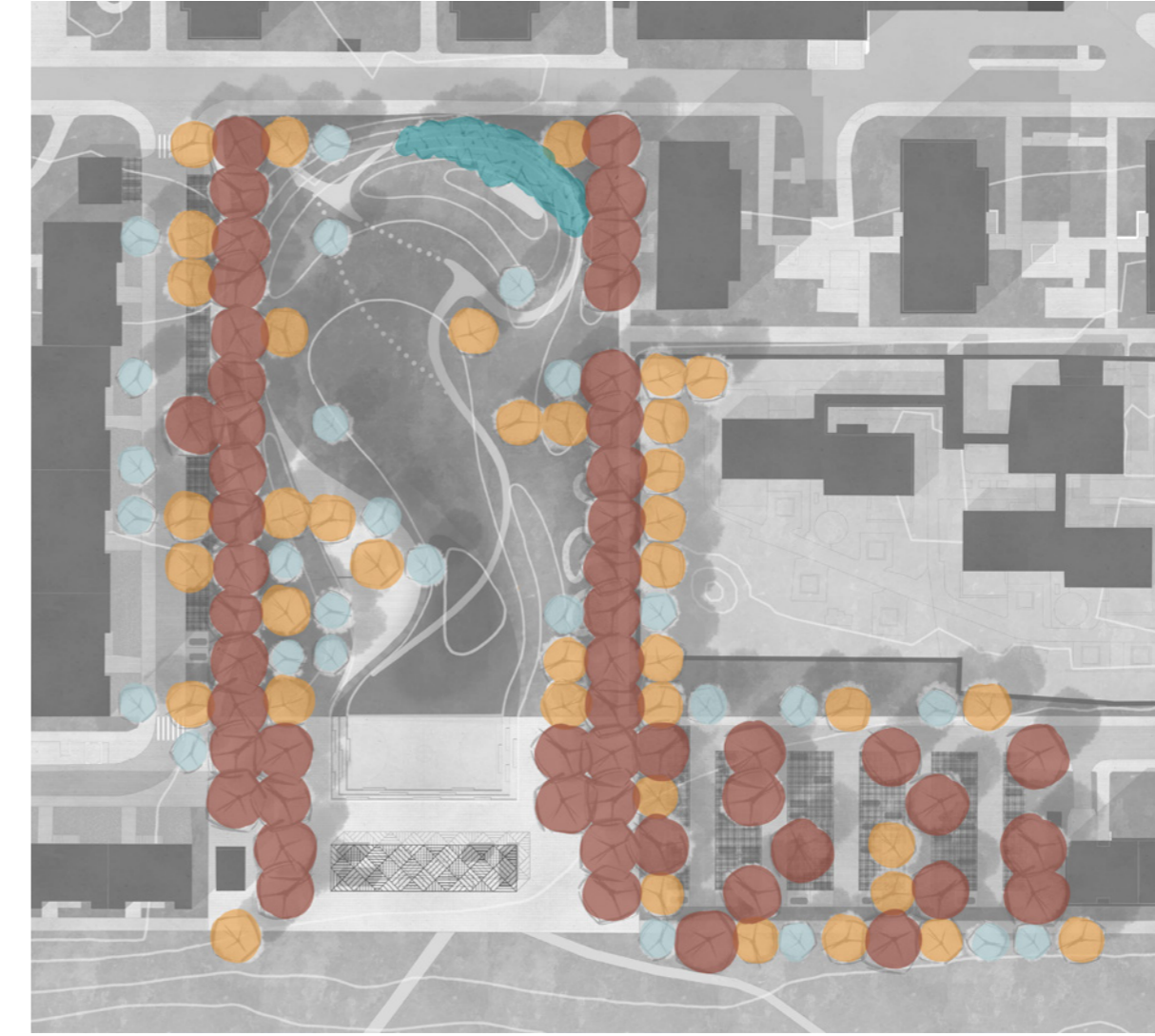

vegetation concept

- big trees
- middle trees
- small trees
- mixed vegetation

- small trees:
Betula pendula
Populus Simonii
- middle trees:
Acer rubrum
- big trees:
Celtis australis
Zelkova serrata



The trees are planted in a grid – a formal pattern coming from the urban structure around the space. The position of the trees is complimenting the view from the community space and the shape of the terrain

section A-A'

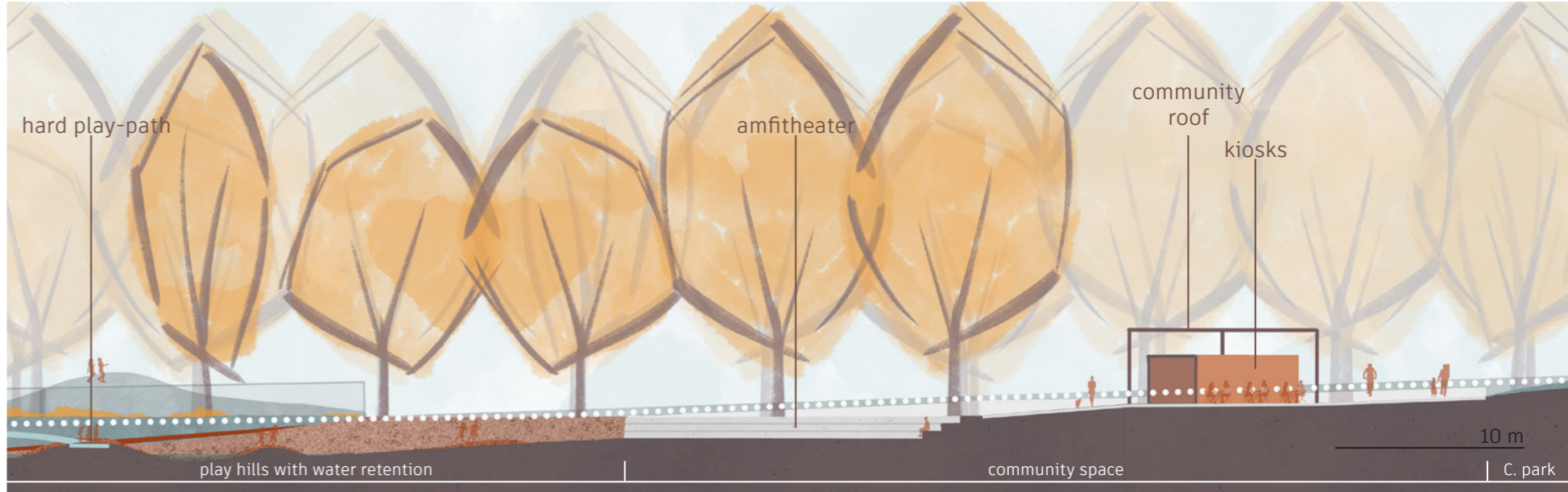
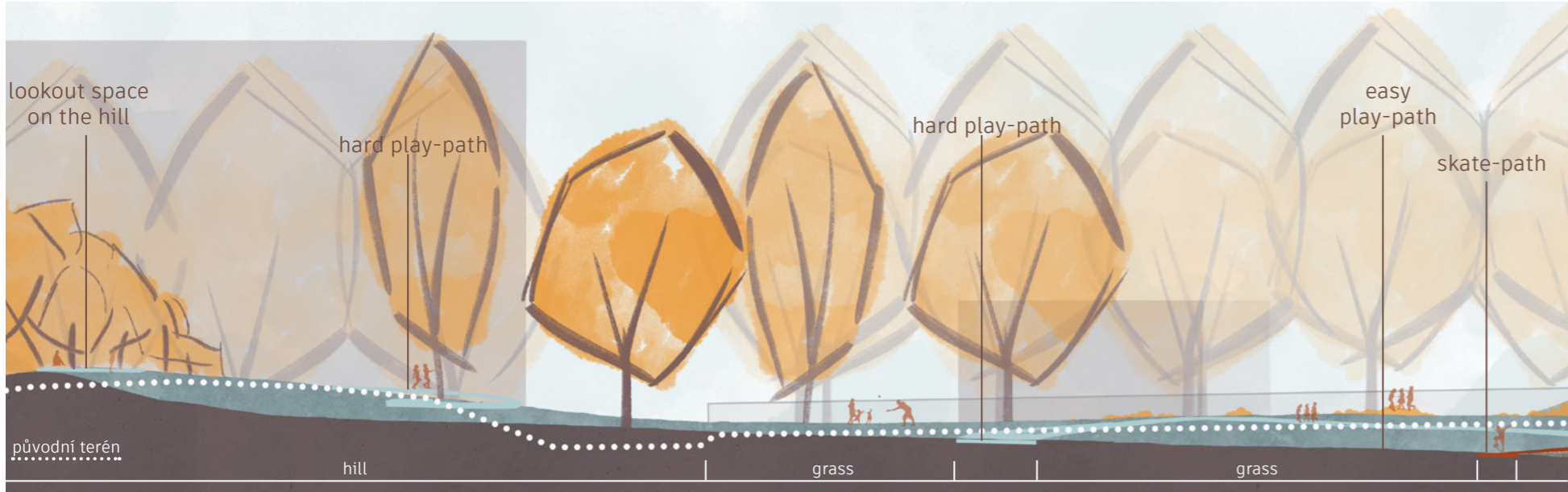

section B-B'

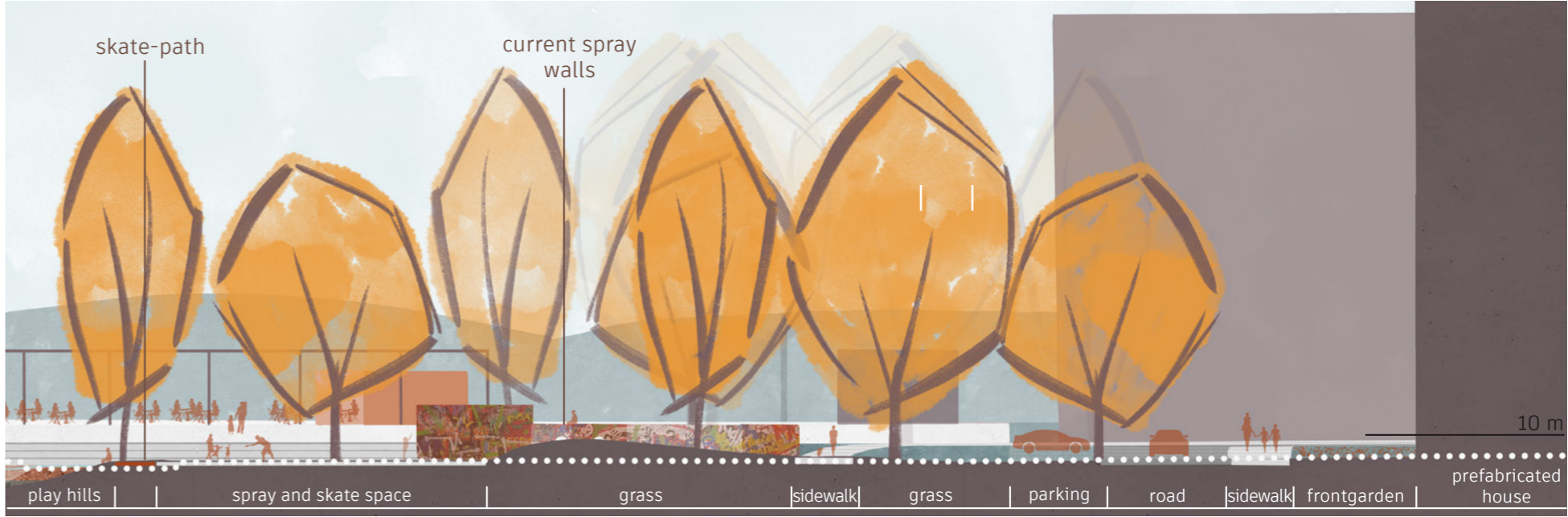
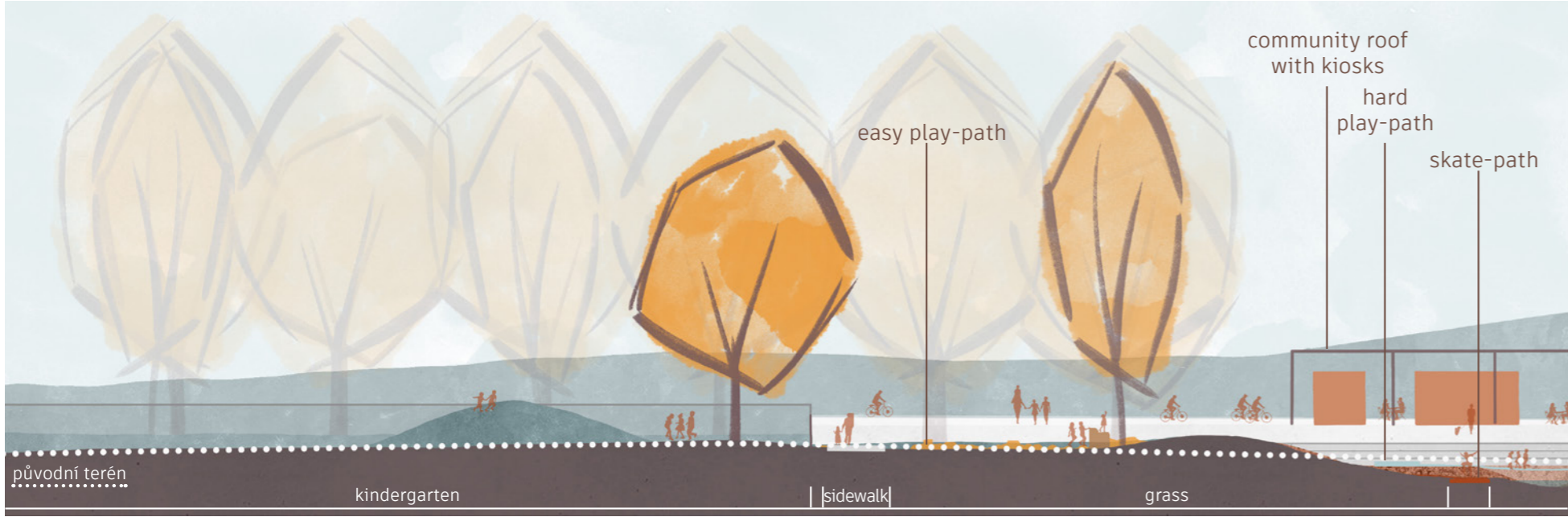



community space

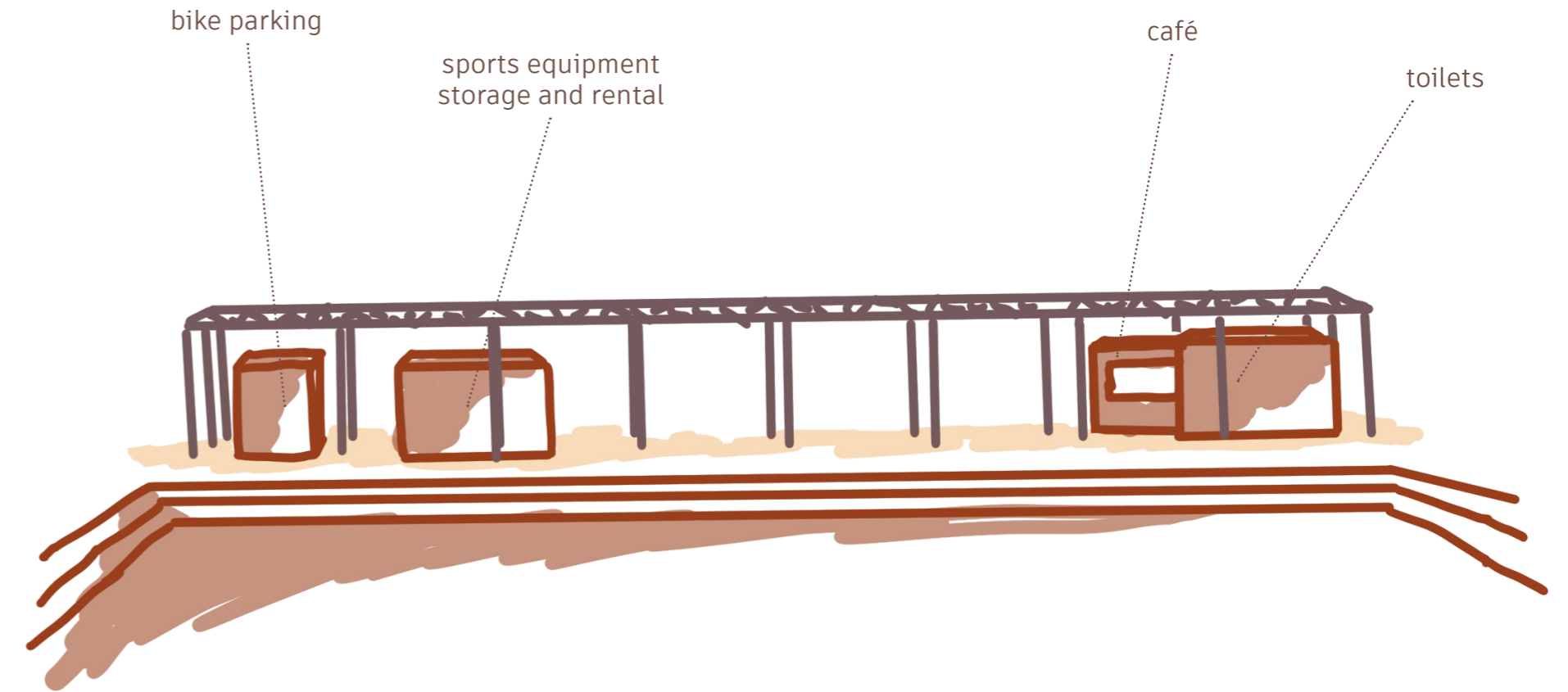

The community roof, there are four kiosks – a café, toilets, sports equipment storage and rental and bike parking. For special events such as seasonal markets, additional four kiosks can be added.

The amfitheater can be used not only for cultural events, but also as a sports field or as an exhibition space. Durong winter, the skating ice can be built here.

special paths and spaces

easy play-path



hard play-path

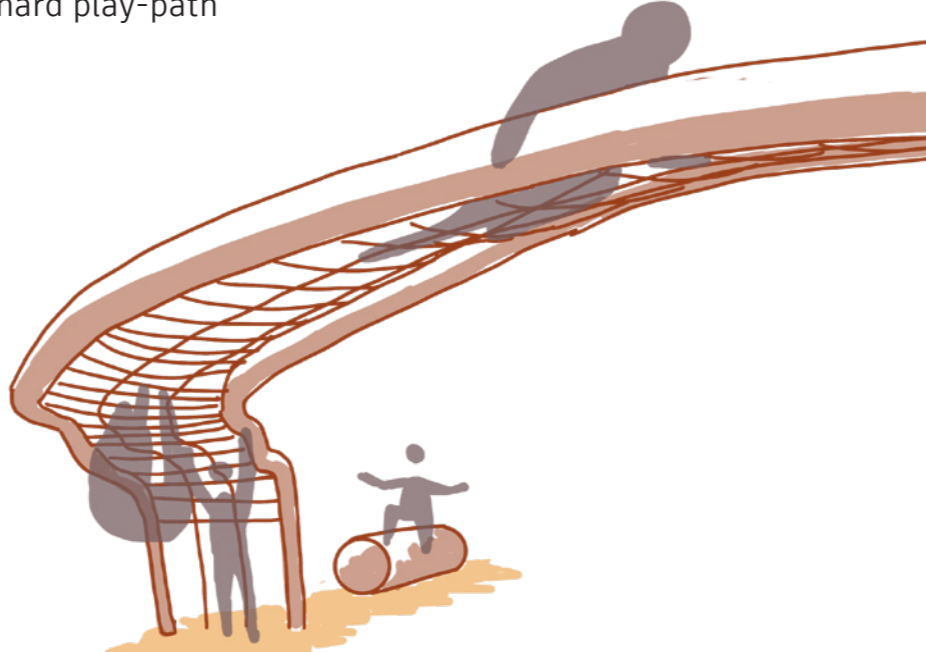

special paths and spaces

skate-path – pump track



play hills with water retention

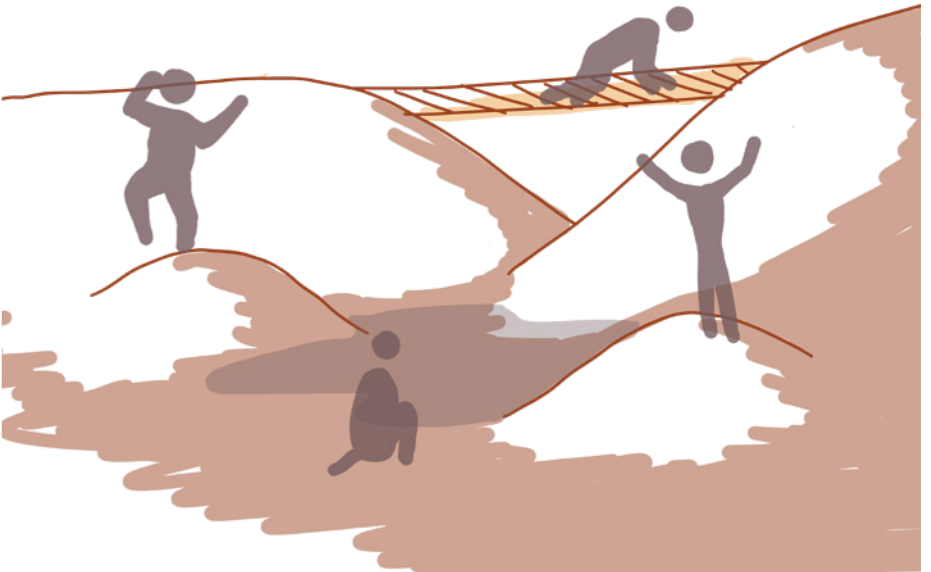

mobiliari

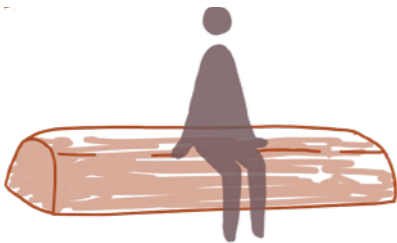

materials



concrete tiles



concrete



parking tiles



grass



colored asphalt

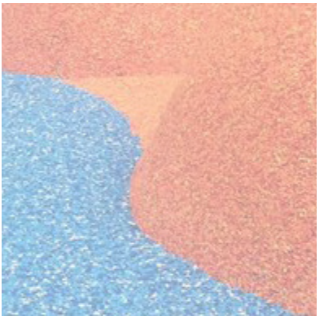

wetpour surface
– orange and blue



wetpour surface
– yellow



steel

model



view from the Central park hills into the space – community roof in the front, playscape in the back



view from the hill to the community space



the easy play-path

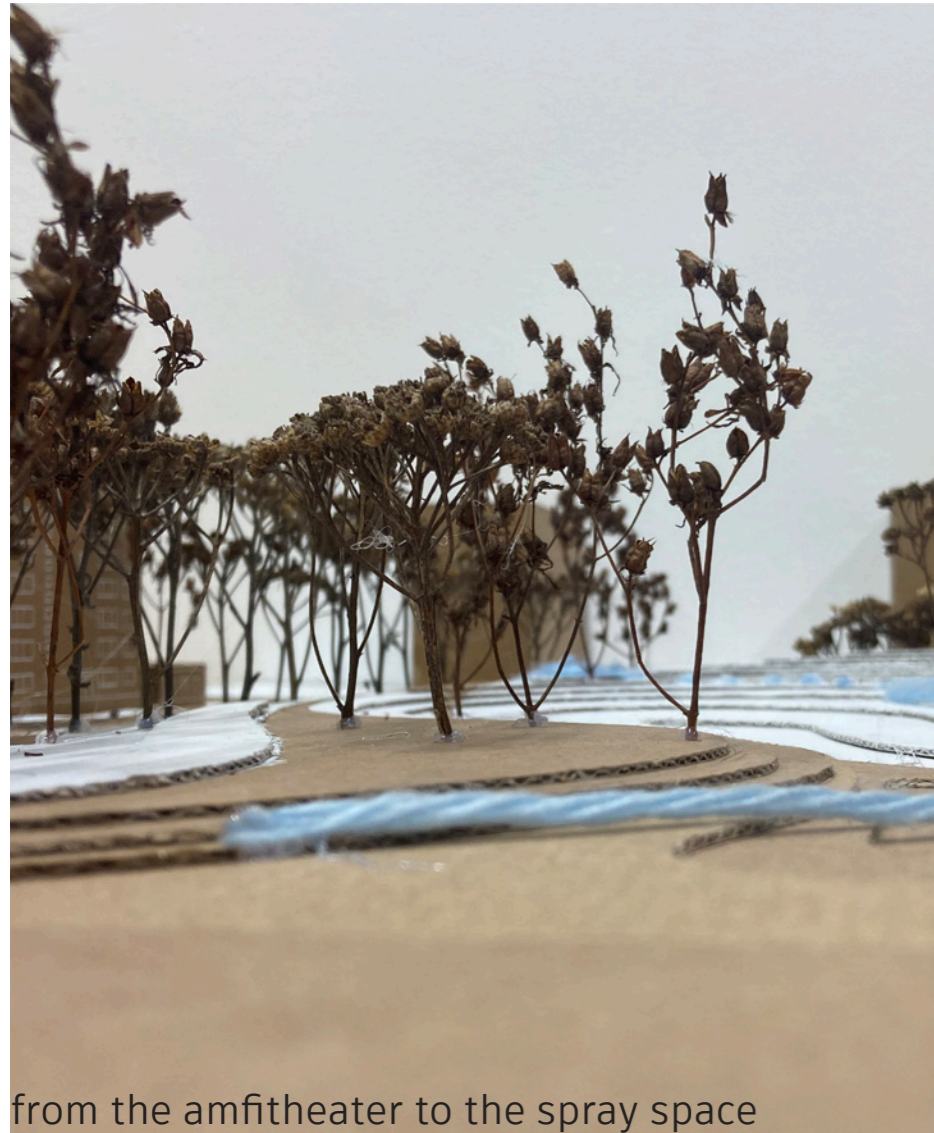

from the amfitheater to the spray space



whole model from above



whole model from east