



**FAKULTA
ARCHITEKTURY
ČVUT V PRAZE**

ÚSTAV KRAJINÁŘSKÉ ARCHITEKTURY

Ing. Klára Salzmann, Ph.D.

Ing. Romana Michalková, Ph.D.

Ing. Karel Slánský

HLEDÁNÍ ZPŮSOBŮ VÝUKY NA TÉMA VODA V KRAJINÁŘSKÉ ARCHITEKTUŘE

Podpora pedagogické práce akademických pracovníků,
profilace a inovace studijních programů na úrovni předmětů/kurzů
Interní soutěž FA ČVUT v rámci Institucionálního plánu ČVUT pro rok 2018 okruh A

Rok 2018

CÍL PROJEKTU

Projekt je zaměřený na vypracování přehledu způsobů výuky tématu vody v krajinářské architektuře u nás a v dalších Evropských zemích. Cílem projektu je zdokonalit náplň předmětu Krajinářská architektura I, Krajinářská architektura II, Dendrologie I, II bakalářského studia a příprava předmětu navazujícího magisterského studia Krajinářská architektura V a Krajinné plánování II.

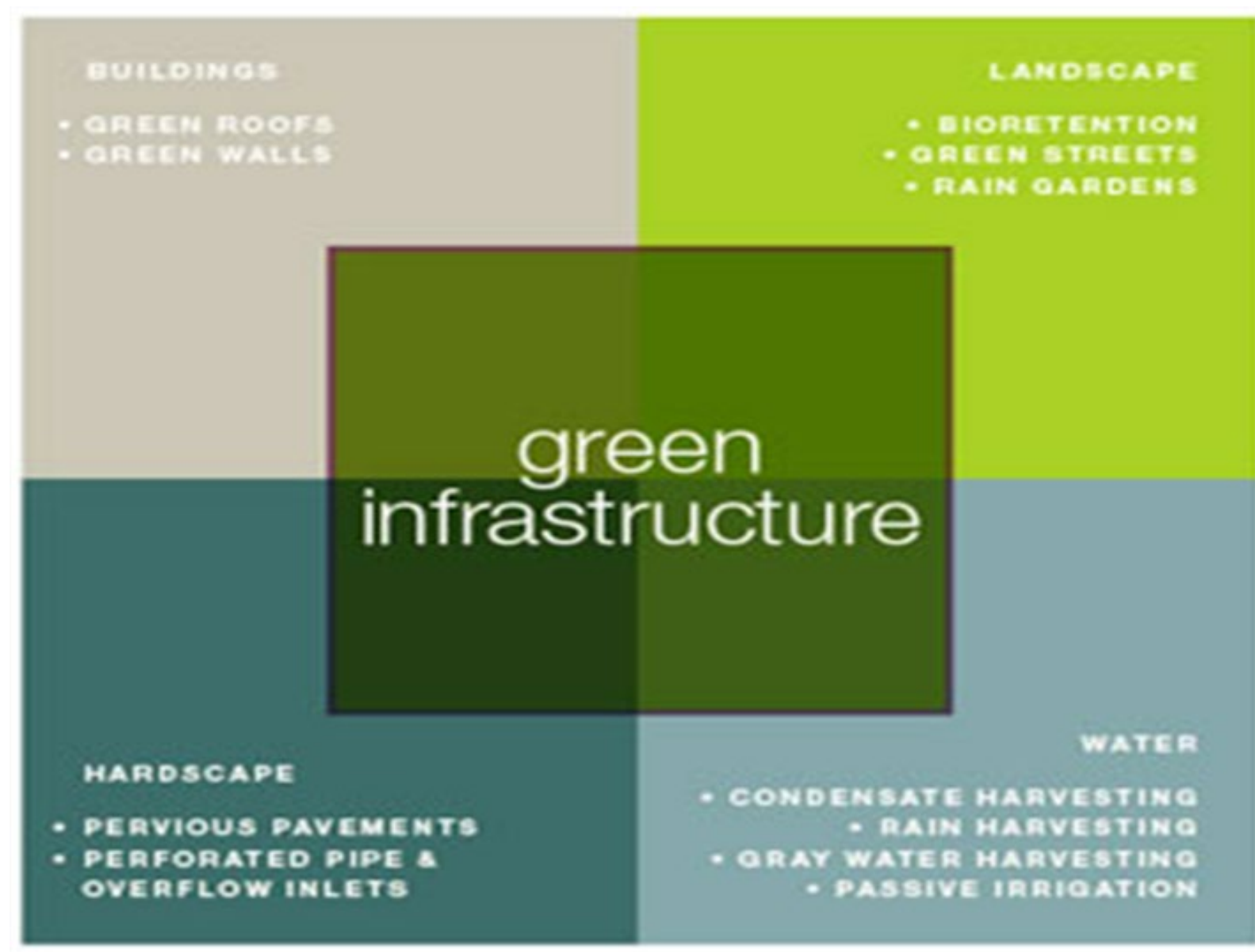

Zelená infrastruktura

zlepšování přírodního kapitálu Evropy

Co to je zelená infrastruktura?

- **vytvořit infrastrukturu s přírodními, polopřírodními, užitkovými či urbanistickými krajinnými strukturami, která přispívá k zachování biologické rozmanitosti a dalších environmentálních faktorů a současně společnosti poskytuje cenově příznivé a udržitelné služby.**
- **HOSPODAŘENÍ S DEŠŤOVOU VODOU**
- **Zelené střechy, zelené stěny, propustné povrchy, atd.**

1. Szt. István University, Budapest, Mad'arsko
2. Donau Universitat Krems, Rakousko
3. Fakultät für Bildung, Kunst und Architektur
Department für Bauen und Umwelt
4. Technische Universität München
5. Wageningen University
6. Arts Academy of Architecture
7. Atelier H+N+S, Amersfoort,
8. GRUPPE F, Landscape Architecture Group, Berlin

Szt. István University, Budapest Faculty of Landscape Architecture

Call for applications 2018-2020



Here is an exciting opportunity to...

- join a landscape architecture faculty with more than a century of practice that offers excellent training for future designers and planners
- hear lectures from award-winning professors (Mihály Mocsényi: Geoffrey Jellicoe Award 2012, Imre Jámor: ECLAS Award 2013)
- study full-time (4-semester degree programme) or part-time (thematic semesters are offered separately)
- meet and work with professors from around the world
- live and study in one of the world's most beautiful, welcoming and affordable cities, with excellent air and rail connections to some of Europe's most famous gardens and landscapes
- complete an MLA programme accredited by IFLA Europe

Contact: H.T.Boglarka@tajk.szie.hu For more information, please visit tajk.szie.hu/english-page/mla or facebook.com/mla.cub

<p>Architectural spatial theory and Contemporary architecture 6ECTS</p> <p>Landscape and garden design 10ECTS</p> <p>Landscape graphics & Communications I. 4ECTS</p> <p>Planting materials and planting design 4ECTS</p> <p>Studies in Urban sociology and ecology 4ECTS</p> <p>Elective 2ECTS</p> <p>I. SEMESTER: GARDEN AND OPEN SPACE DESIGN</p>	<p>Ecology and plant materials of historic landscapes 4ECTS</p> <p>Design of historic landscapes and sites 8ECTS</p> <p>Renewal methods and design principles of historic gardens and urban open spaces 8ECTS</p> <p>Landscape graphics & Communications II. 4ECTS</p> <p>History of garden art and landscapes 4ECTS</p> <p>Elective 2ECTS</p> <p>II. SEMESTER: HISTORIC GARDEN AND LANDSCAPE DESIGN</p>	<p>Planting design in landscape renewal projects 4ECTS</p> <p>Sustainable Landscape Design and Planning 6ECTS</p> <p>Regional Planning 6ECTS</p> <p>Landscape graphics & Communications I. 4ECTS</p> <p>Urban landscapes - urban green systems 8ECTS</p> <p>Elective 2ECTS</p> <p>III. SEMESTER: LANDSCAPE PLANNING AND DESIGN</p>	<p>Digital presentation techniques 4ECTS</p> <p>Thesis (individual design) in Landscape Design 22ECTS</p> <p>Tendencies in landscape architecture theory 4ECTS</p> <p>IV. SEMESTER: FINAL THESIS</p>
---	---	---	---

Duration
September 2018 – June 2020

Tuition Fee
Euro 2900/semester-
Euro 5000/two semesters

Regular application deadline
31 May 2018

Language
English

MASTER in LANDSCAPE ARCHITECTURE
accredited by IFLA Europe

FACULTY OF LANDSCAPE ARCHITECTURE AND URBANISM - SZENT ISTVÁN UNIVERSITY



Ústav ochrany a rehabilitace krajiny



Ústav pro design veřejných prostranství a zahrad

Imre Makovecz

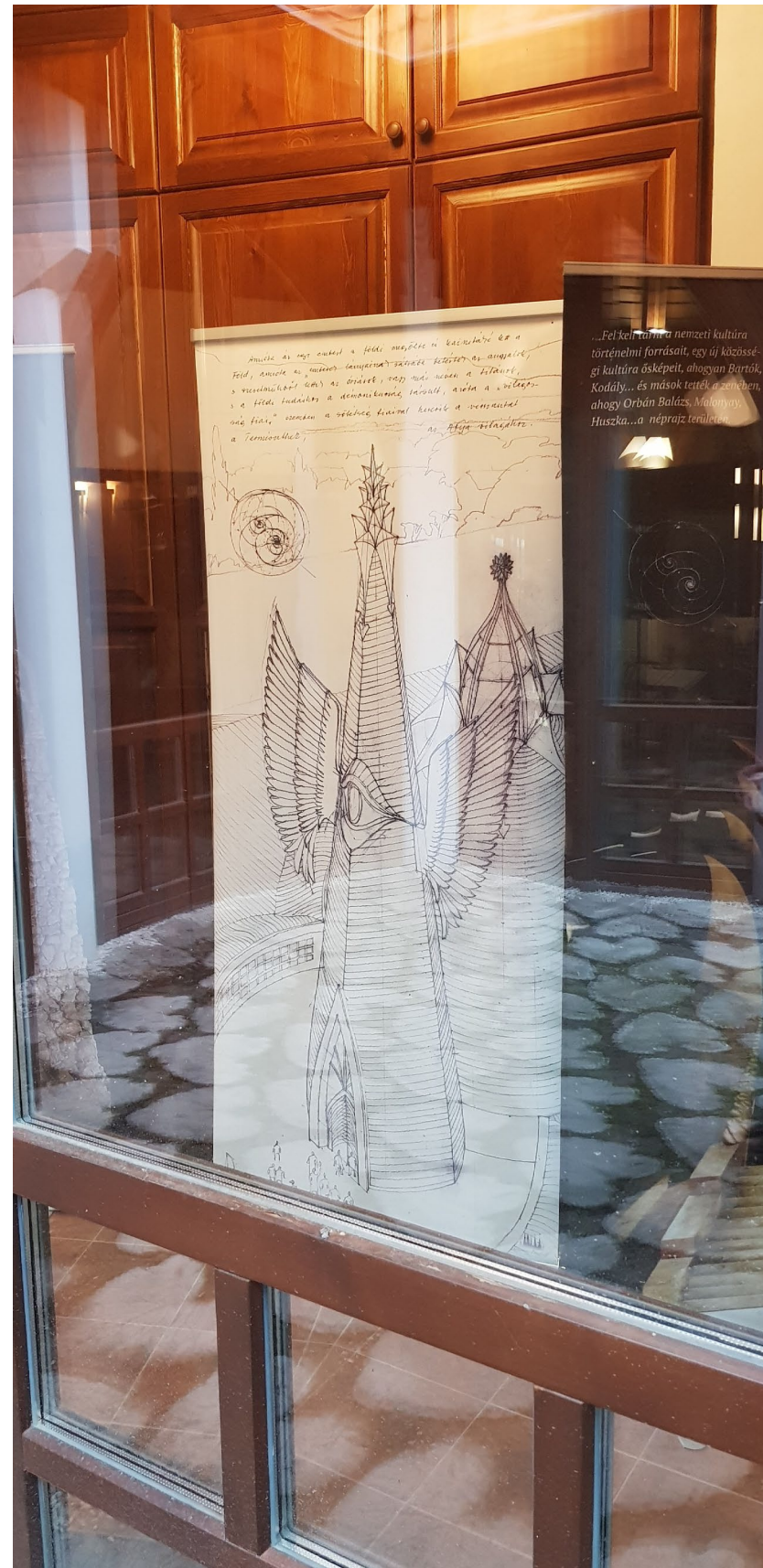

Donau Universität Krems

Fakultät für Bildung, Kunst und Architektur

Department für Bauen und Umwelt





Dr. Christine Rottenbacher

Tulln



GRUPPE F

Landscape Architecture Group

Berlin



Dipl.-Ing. Dr. Antje Backhaus

Urban Stormwater Landscapes - Values and Design

B. Water dynamics and dimensioning



Photo 7. Monnikenhuizen.
Infiltration pond for stormwater runoff with low water level after a longer dry period.



Photo 8. Monnikenhuizen.
Infiltration pond for stormwater runoff during a rain event, which results in a higher water level and the sculpture spewing water.

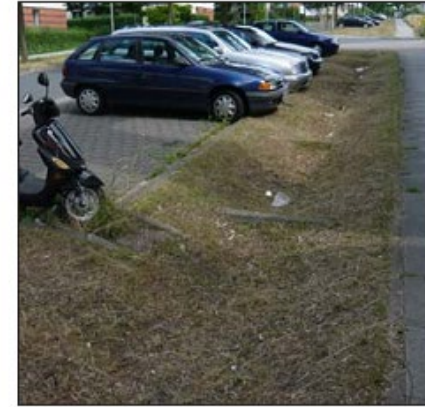

Photo 9. Kronsberg.
Swale infiltration system with a sequential retention of water in small depressions.



Photo 10. Kronsberg.
Swales are located along a sloping terrain and concrete weirs are implemented downhill to avoid too large runoff flow rates.



Photo 11. Scharnhorst Ost
Water playground in a backyard.

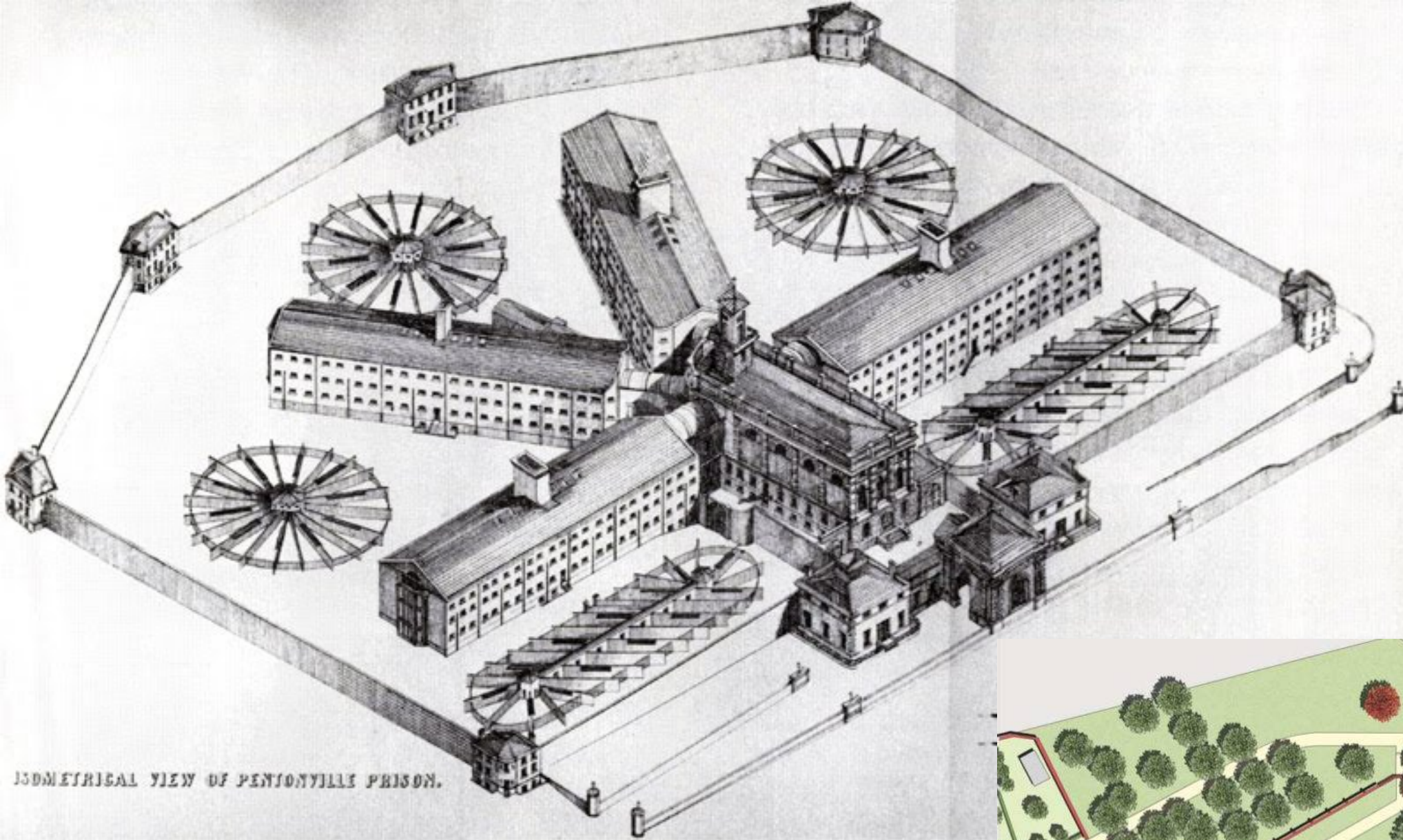

Photo 12. Scharnhorst Ost.
Small artificial creek for play and recreation. The water derives from a runoff collection tank located under the small hill and is pumped (use of photovoltaic) through the system to ensure a continuous flow of water.

LEISE - PARK Berlín

Heinrich-Roller Strasse





ISOMETRICAL VIEW OF PENTONVILLE PRISON.

Prison Moabit Berlín
Invalidenstrasse



Prison Moabit Berlín





Městský park Spreebogenpark
Ludwig-Erhard-Ufer



Studienfakultät Landschaftsarchitektur und Landschaftsplanung der TU München / Freising

Studienfakultät Landschaftsarchitektur und Landschaftsplanung der TU München
Wissenschaftszentrum Weihenstephan für Ernährung, Landnutzung und Umwelt
Technische Universität München



- Startseite
- Aktuelles
- Studiengänge +
- Lehrstühle
- International Studieren +
- Studieren in Weihenstephan und München
- Studentische Vertretung
- Berufsaussichten +
- LandschaftPlus
- Archiv +
- Studienzuschüsse
- Alumni Club Landschaft der TUM e.V.
- Fragen und Antworten
- Kontakt und Bewerbung



**Herzlich willkommen auf der Homepage der Studienfakultät
Landschaftsarchitektur und Landschaftsplanung an der Technischen
Universität München**

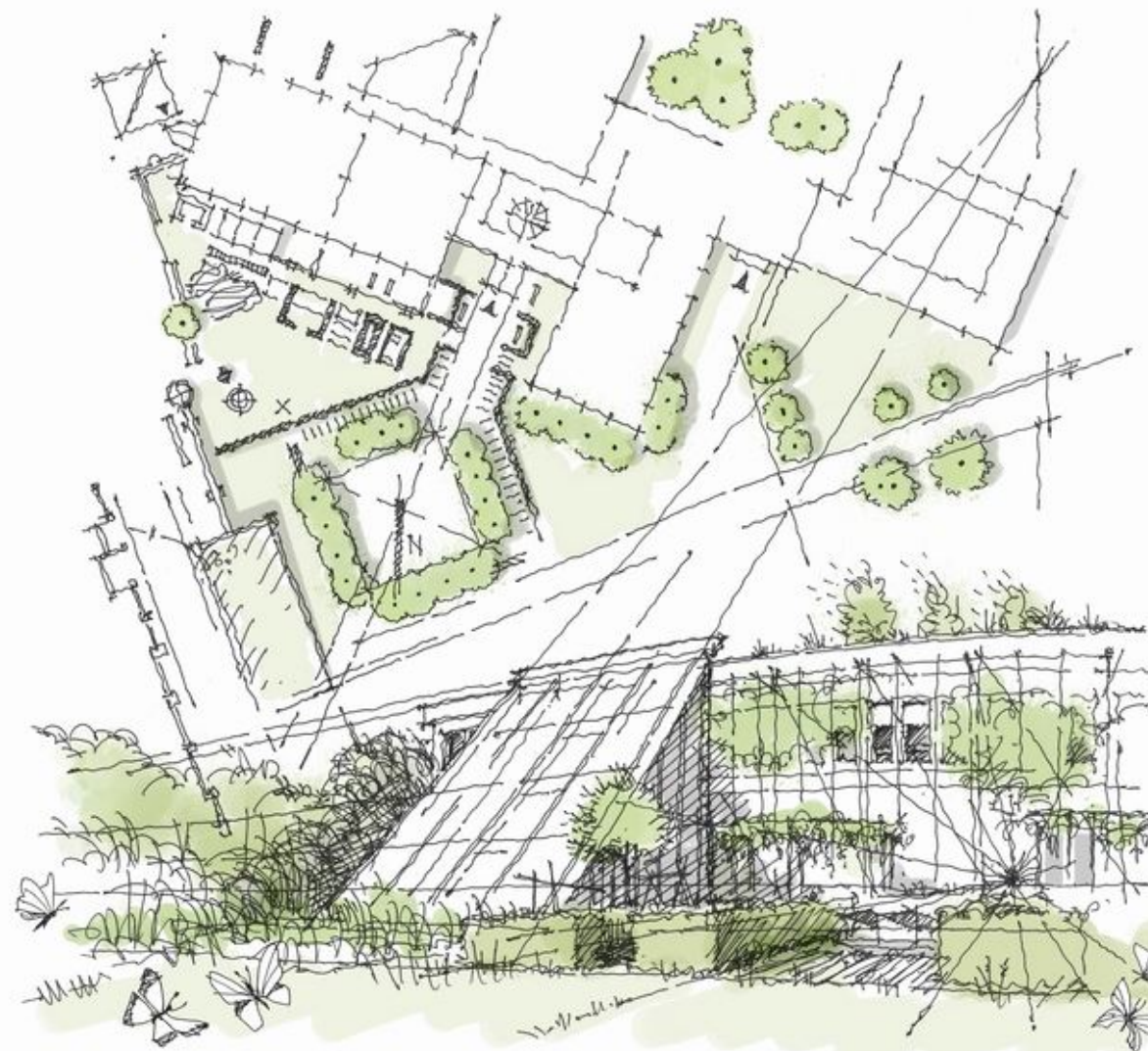

**Studienfakultät
Landschaftsarchitektur
und Landschaftsplanung
der TU München**

Emil-Ramann-Straße 6
85354 Freising

Tel.: +49 8161 71 4147
E-Mail: [senden](#)



Landschaft.Plus
auf social media

[Blog.Landschaft.Plus](#)



News

17.02.2019
[draußen ist draußen](#) →

04.12.2018
[1. Preis für die
Landschaftsarchitektur-
Masterthesis von Johann
Stimpfle](#) →

04.12.2018
[Vernissage und
Buchpräsentation URBEEN](#) →

01.12.2018
[URBEEN auf dem Advents-
Hoffest des
Landwirtschaftsministeriums](#) →

21.11.2018
[Nachwuchspreis des BDLA
an TUM-StudentInnen
Landschaftsarchitektur](#) →



Prof. Dr. Stephan Pauleit



výstava studentských prací



ukázka jedné ze studentských prací

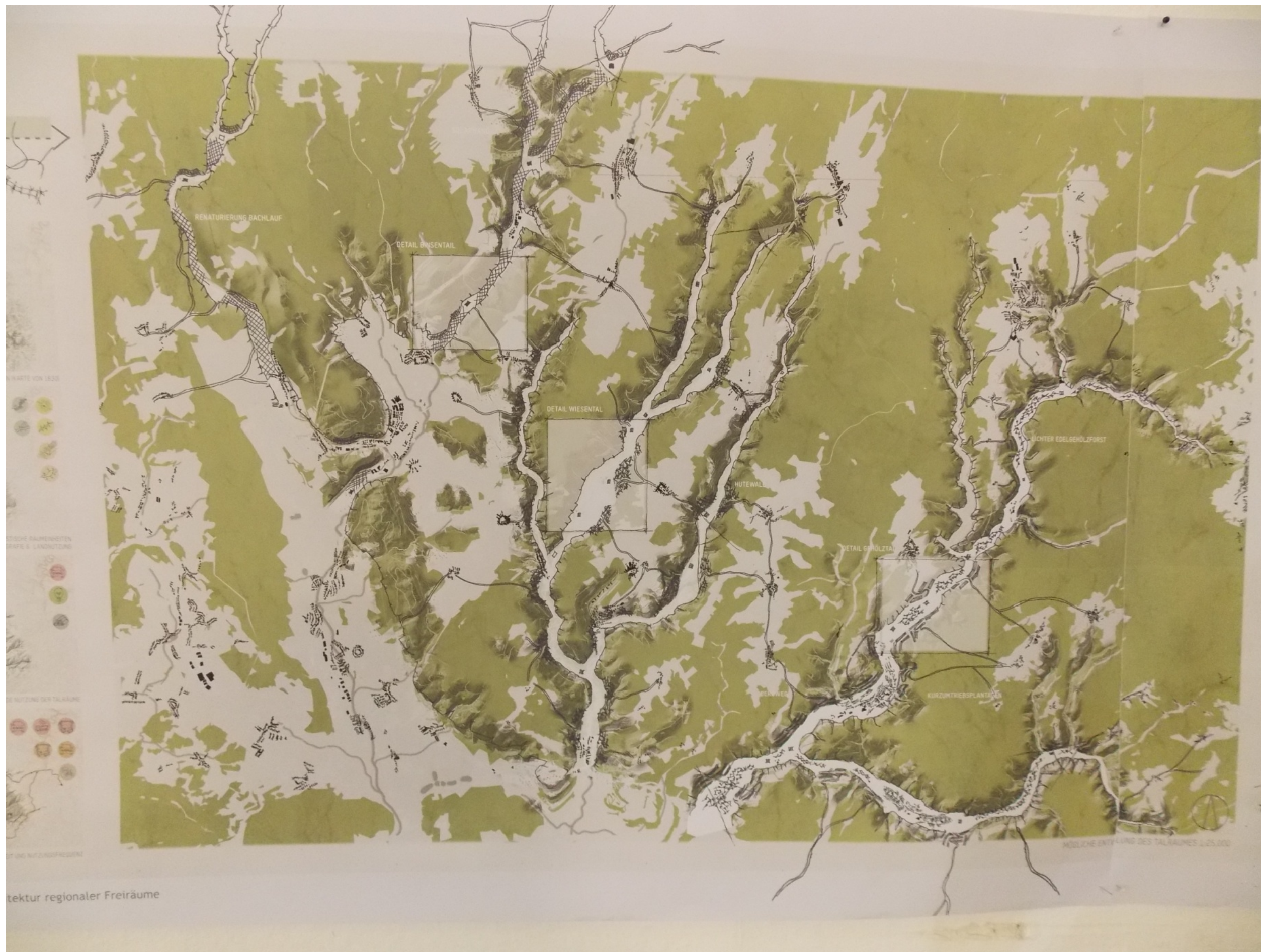

Sichtungsgarten Freising



H+N+S Landscape Architects / Amersfoort

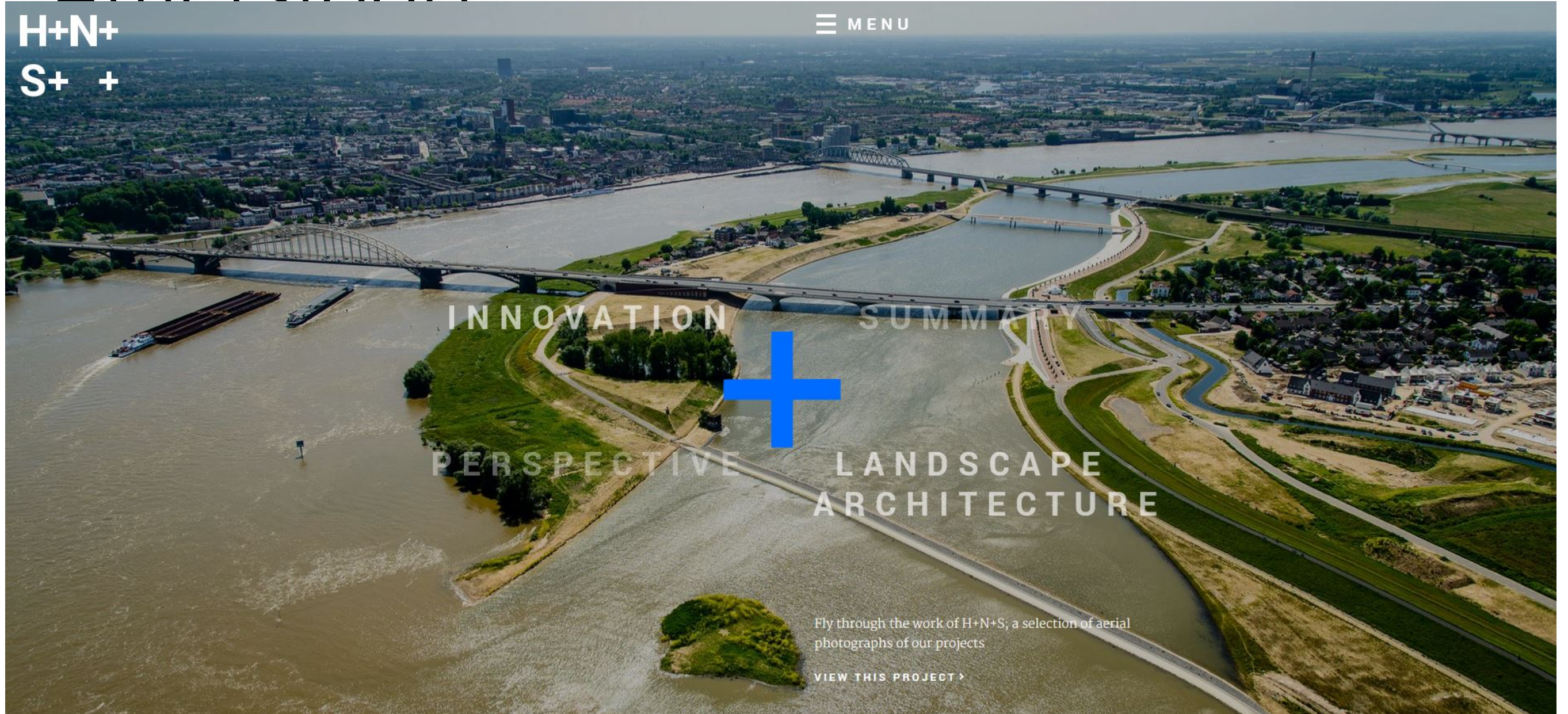





JANDIRK HOEKSTRA
ADVISOR, LANDSCAPE
ARCHITECT



PIETER SCHENGENGA
DIRECTOR, LANDSCAPE
ARCHITECT

Prostor pro řeku Nijmegen

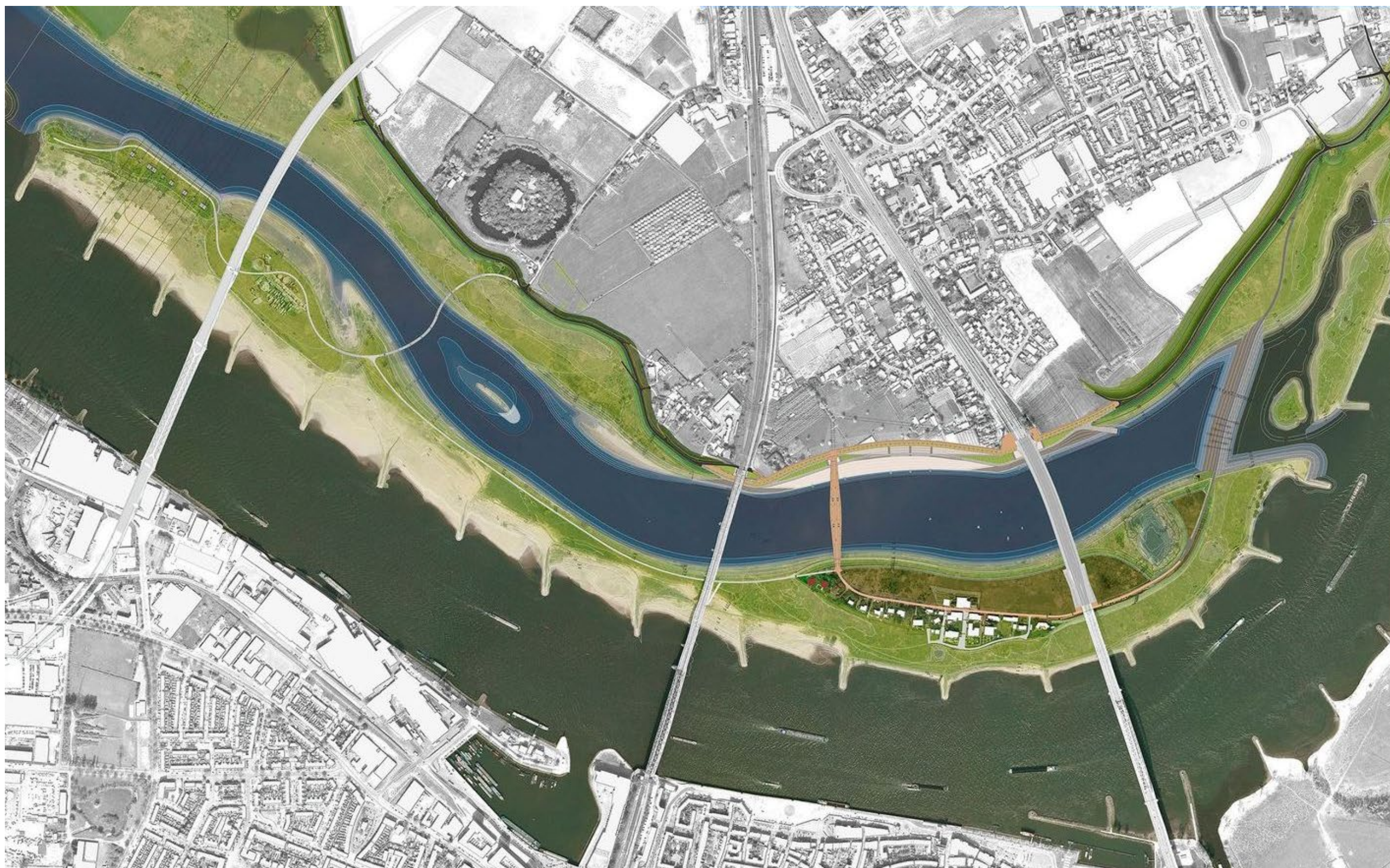







Univerzita Wageningen



[About Wageningen](#) [Career](#) [Contact](#) [Login](#)

en|English

[Education & Programmes](#)

[Research & Results](#)

[Value Creation & Cooperation](#)



[Home](#)

[Research & Results](#)

[Chair groups](#)

[Landscape Architecture Group](#)

Landscape Architecture Group

We address present and future challenges, such as climate change, the human perception of landscape, water management, urbanisation and energy transition, through landscape design. Our specific competence is to deal with the various scales of complex and dynamic landscape systems and to propose inspiring and meaningful solutions.



Secretary

AM (Audrey) Raijmann-Schut

[Contact form](#)

[Publications](#)

[People](#)

[Research](#)

[Education](#)

[Collaboration](#)

[About us](#)

[Competitions](#)

[Contact](#)

[Links](#)

Featured

[Clever and cool
Generating design
guidelines for climate-
responsive urban
green infrastructure](#)

[Read more](#)



prof.dr.ir. A (Adri) van den Brink
Professor



Vacancy



prof.dr.ir. Adri van den Brink



jedno z ateliérových zadání zelenomodré infrastruktury

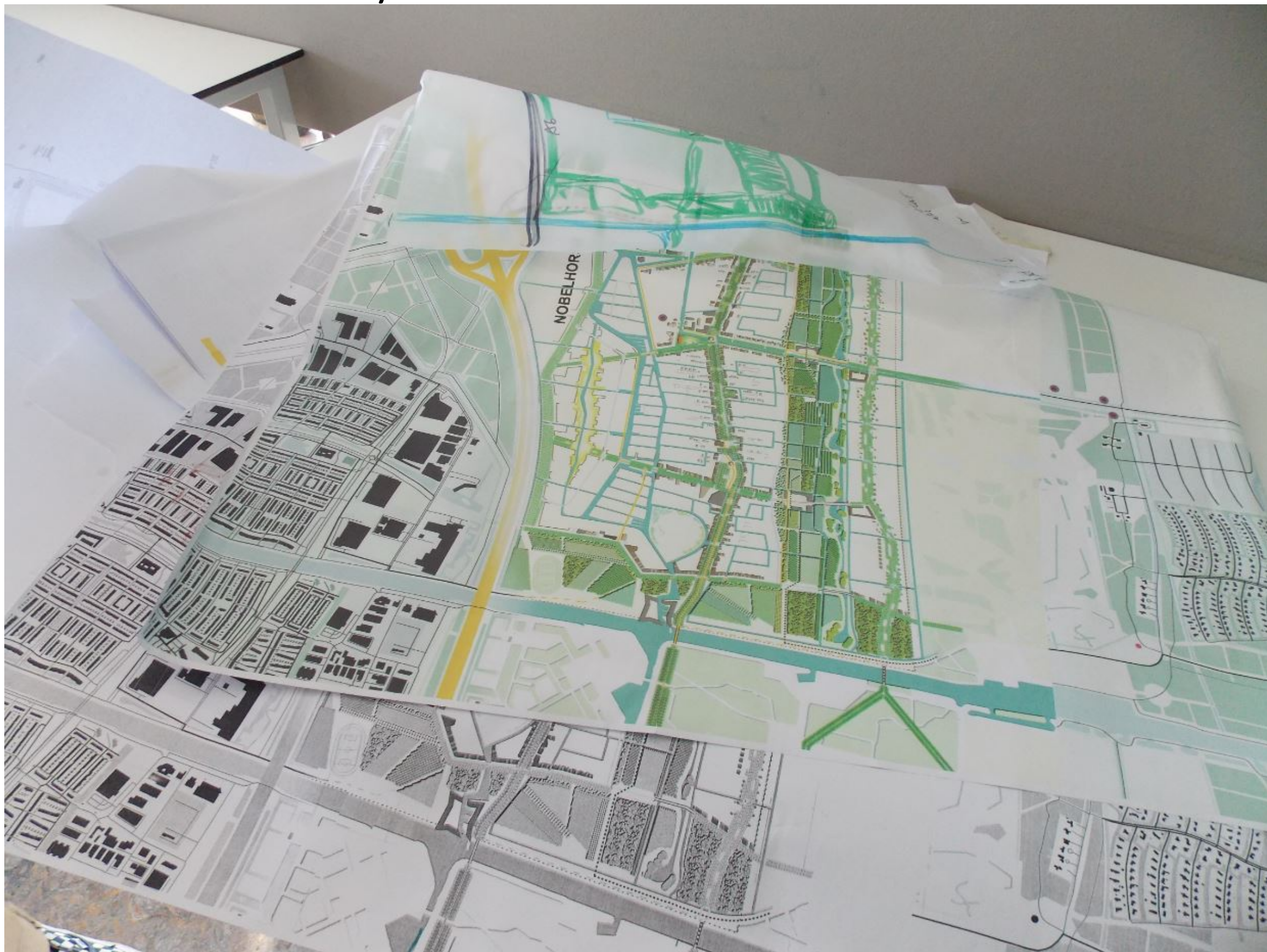

studenti v atelieru



dr. Bas Pedroli

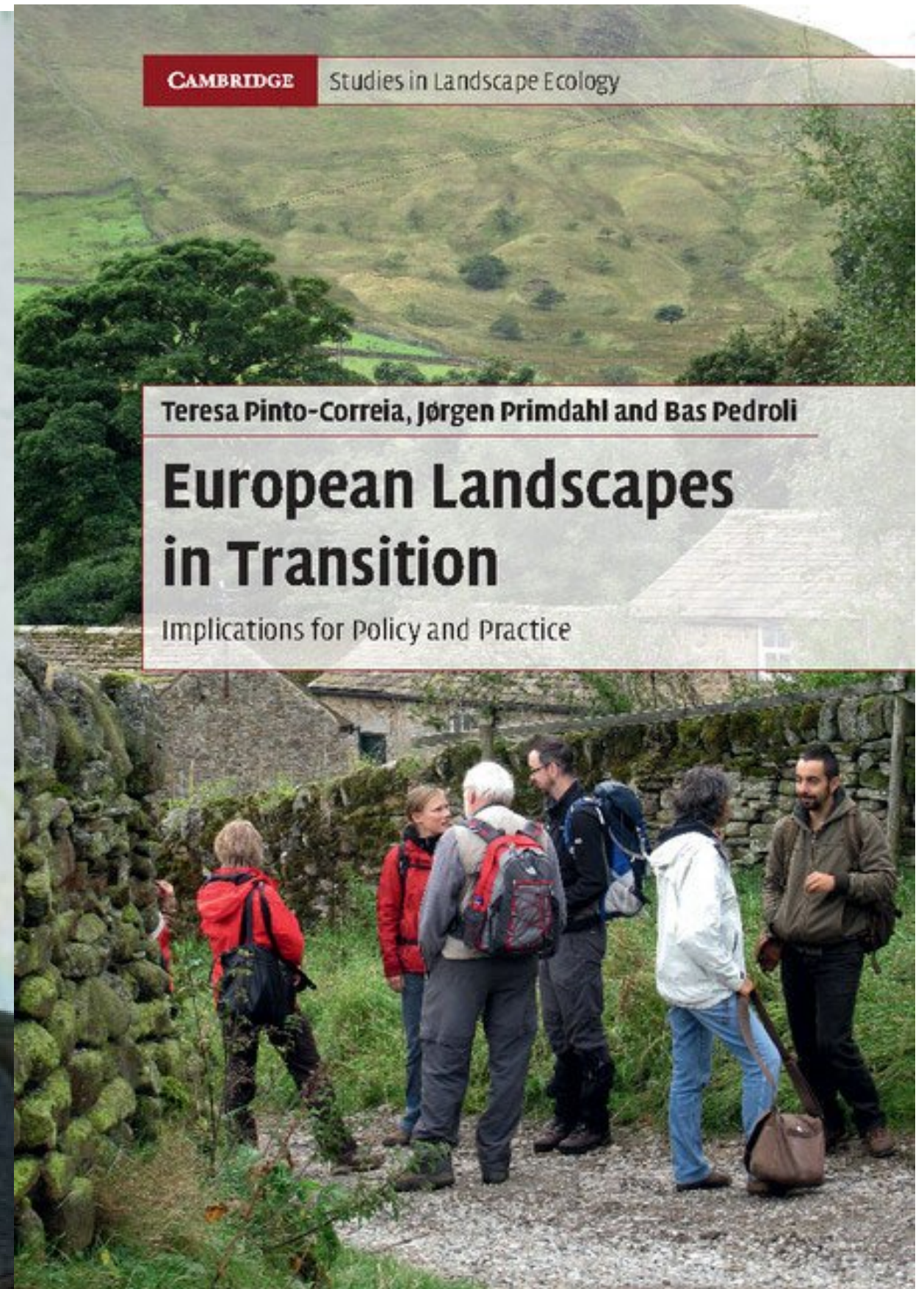

Akademie architektur Amsterdam



Academy of Architecture
Amsterdam University of the Arts



Master in Landscape Architecture

[Study programme](#) [Application and admission](#) [Career prospects](#)

Master in Landscape Architecture

Landscape Architecture is sometimes described as 'drawing in the topography', but the profession encompasses much more. During the Master's programme at the Amsterdam Academy of Architecture, you will acquire the knowledge, insight and skills that make it possible to solve spatial problems through design and to shed light on new topographical situations. This will take place at different scale levels, from garden to region.



Mildred van der Zwan / Hanneke Kijne / David Keuning



Hanneke Kijne na vernisáži studentských prací



jedna ze studentských prací na vernisáži s tématem řeky





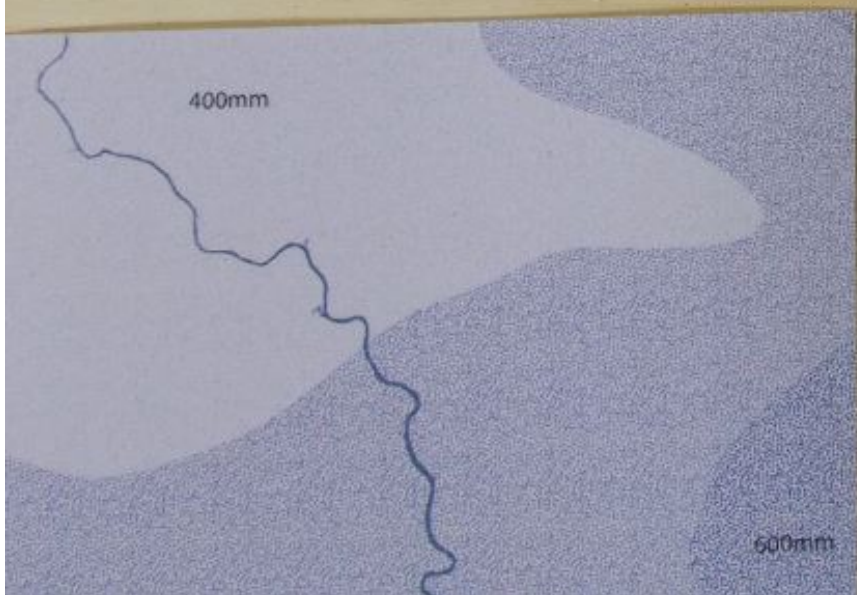
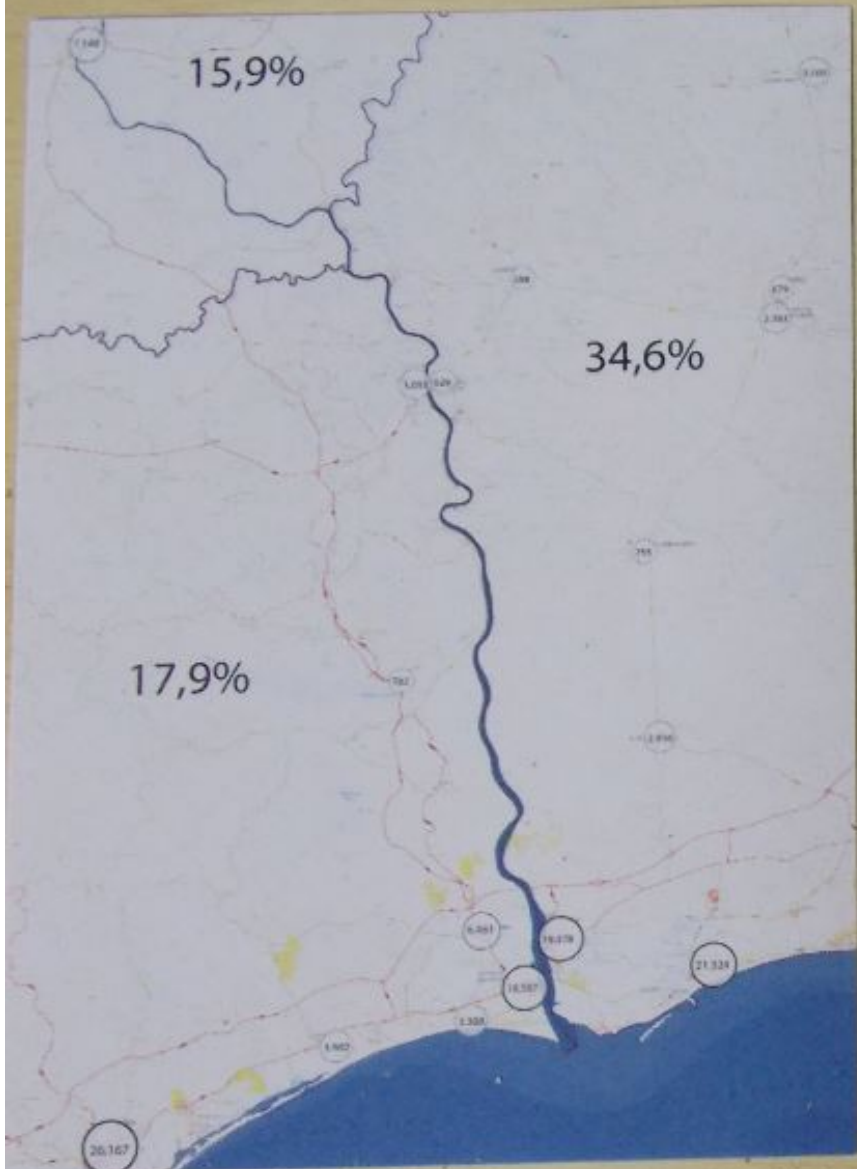

Evolving Lower Guadiana

"A river that unites us"



LOURDES BARRIOS AYALA

Utrecht



Utrecht Centraal



Utrecht Centraal



Oudegracht





Janskerkhof